

ROLL UP TRUCK BOX COVER SPECIAL SHIM AND CLAMP INSTRUCTIONS



2015-ON CHEVY COLORADO/GMC CANYON

Read and follow these special instructions along with the standard instructions carefully before installing or using this cover.

NOTICE TO INSTALLER: Even if familiar with product, read special instructions prior to installation as improvements may be made without notice. Always handle components with care. When done, these special instructions must be given to the consumer.

NOTICE TO CONSUMER: Before using this product, read special instructions. Save these special instructions for future reference.

NOTICE TO INSTALLER/CONSUMER: These instructions supersede the side rail installation step found in the standard instructions. After side rails are installed, resume standard instructions.

PREPARATION

IMPORTANT: Include shim with clamp. Clamp only where two layers of sheet metal are present.

TOOLS NEEDED

- (1) 1/2" Wrench
- (1) Foot-pound torque wrench with 1/2" socket
- (1) Protective eyewear

▲ CAUTION: Over torquing hardware may damage components. Do not use impact tools.

NOTE: For best adhesion, air and surface temperature should be above 60° F.

1. INSTALLING SHIMS AND SHORT CLAMPS

A. Clean area where shims will be installed. Peel paper back and adhere shims to box rail between box rail protector and box rail at locations specified in Step 1 of standard instructions. Shim should be flush with bottom of the box rail protector.

NOTE: If shim causes rail protector to bulge, reinstall shim lower.

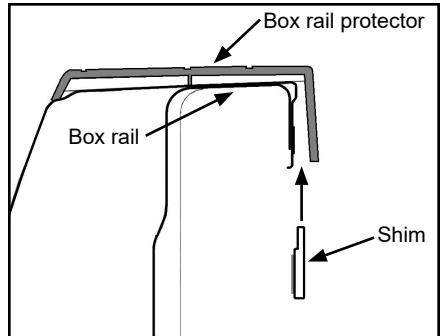

B. Install clamp at each shim location. Orient clamp halves so long legs are toward bottom.

NOTE: Most short box kits contain 6 clamps. Install 3 per side. For kits with 8 total clamps, install 4th clamp between 2nd and 3rd clamps on each side.

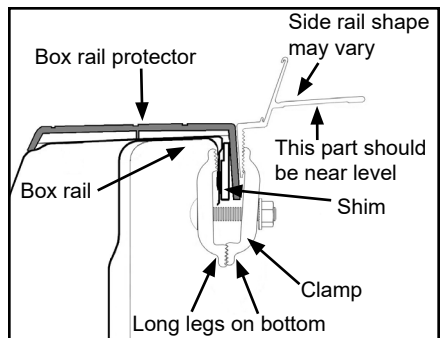

2. INSTALLING LONG CLAMPS

A. After short clamps are installed (as shown on page 2), at rear of box under large hole in line with stake pocket, clean area and apply self adhesive protective strip.

NOTE: If box has drop-in liner, cut liner to clear room for clamp.



B. At top of rear stake pocket, lower back half of long clamp with fish wire and carriage bolt into pocket.

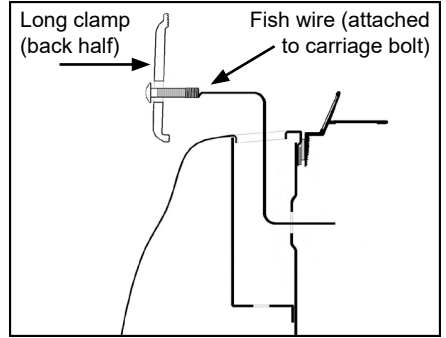

C. Using fish wire, align and pull bolt through hole on inside wall of box and hold there for next step.

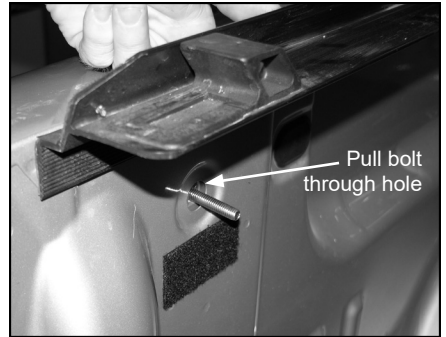

D. Place other half of clamp over bolt and turn nut finger tight.

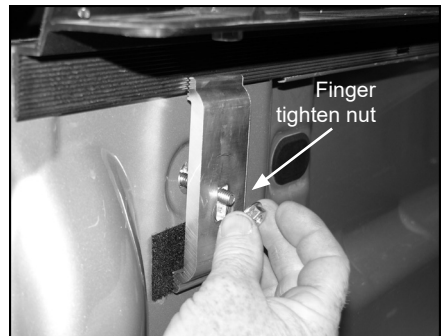

2. INSTALLING LONG CLAMPS (Continued)

E. Use standard instructions for the correct height and position of side rail and hold. Push clamp up under side rail and tighten bolt. Torque this bolt to 18 ft-lbs. Repeat for opposite side.

NOTE: Ensure clamps are properly aligned prior to tightening bolts.

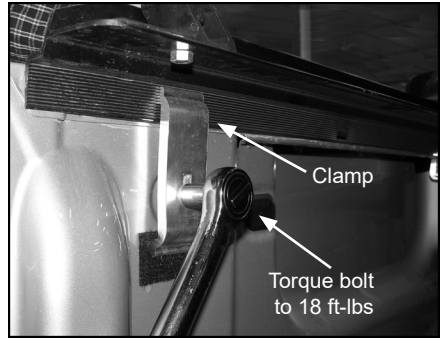

NOTE: Only if stake pocket is unavailable, use the following long clamp location with shims. Even if stake pocket is utilized with an accessory, remove it and check for space. Usually the long clamp will install in the pocket and still allow the accessory to be remounted.

F. For remaining cover installation, refer to standard instructions

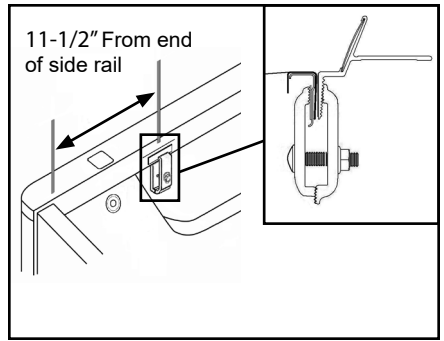

TALL CLAMPS INSIDE REAR STAKE POCKET

