



TRUCK BED MAT INSTALLATION INSTRUCTIONS

NOTICE TO INSTALLER: Even if familiar with product, read these instructions prior to installation as improvements may be made without notice. Always handle components with care. When done, these instructions must be given to the consumer.

NOTICE TO CONSUMER: Before using this product, read instructions. Save these instructions for future reference.

PREPARATION

Unpack bed mat components and clean truck bed.

TOOLS NEEDED

- Drill with 7/64" bit
- #2 Phillips screwdriver
- Tape measure
- Protective eyewear
- Marking pen

SAFETY INFORMATION

IMPORTANT: Inspect box for hidden components such as electrical wiring, fuel lines or other areas of concern before drilling, make adjustments as needed.

NOTE: Trucks with bed accessories such as a fifth wheel hitch requires small slit cuts to allow accessory to protrude through bed mat surface.

1: PLACING TRUCK BED MAT

A. Center bed mat between wheel wells with carpet side up.

NOTE: For models without wheel wells, center mat between truck bed walls.

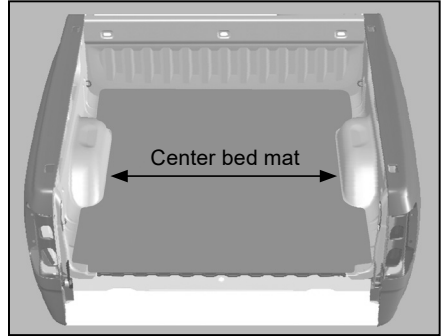

B. Adjust bed mat at front (behind cab) 1/4" away from box wall. Ensure bed mat at rear is 1/2" away from edge of bed.

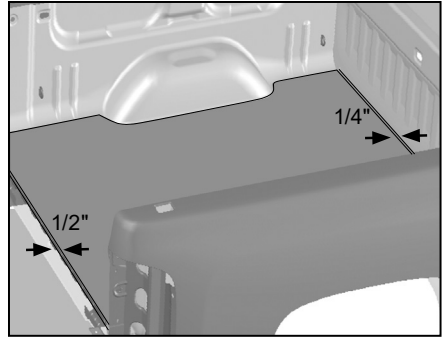

2: INSTALLING BED MAT

Perform one of the following to install bed mat:

DRILLING SNAP

A. Starting at driver's side corner near tailgate, use hole in snap attached to bed mat as template to mark location.

B. Ensure bed mat is in its correct position. Lift corner of bed mat up and drill 7/64" hole into surface layer of truck bed.

IMPORTANT: Remove all metal shavings from underneath bed mat.

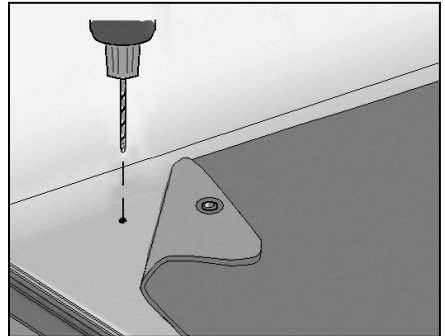

2: INSTALLING BED MAT (Continued)

C. Position male snap over hole and fasten with Phillips screw. **Use care not to strip threads or snap screw.** Then press snaps together.

D. Repeat procedure on opposite rear corner, followed by rear center snap.

E. Install remaining snaps in the same order working from the tailgate to the cab.

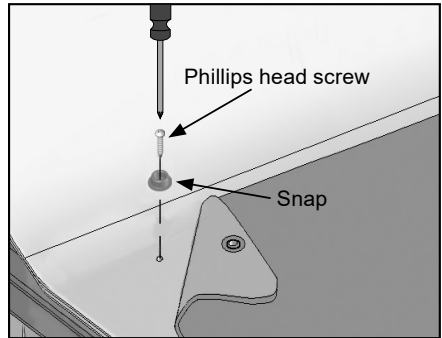

ADHESIVE SNAP

NOTE: For best adhesion, air and surface temperature should be above 60° F.

A. Attach each adhesive snap to snaps on bottom of bed mat. **Do not peel protective layer off adhesive.**

B. Starting at driver's side corner near tailgate of bed mat, lift corner up. Clean area on bed where adhesive snap will adhere with alcohol wipe and let dry.

NOTE: If needed, trim adhesive snap to fit flat surface of bed.

IMPORTANT: Do not touch adhesive.

C. Ensure bed mat is in its correct position. Peel protective layer off then press adhesive snap firmly onto bed. Gently lift bed mat to separate snaps. For maximum adhesion, press around all edges and center of snap. Reattach snaps together.

D. Repeat procedure on opposite rear corner, followed by rear center snap.

E. Install remaining snaps in the same order working from the tailgate to the cab.

