

Rocker Switch and Solenoid Instructions

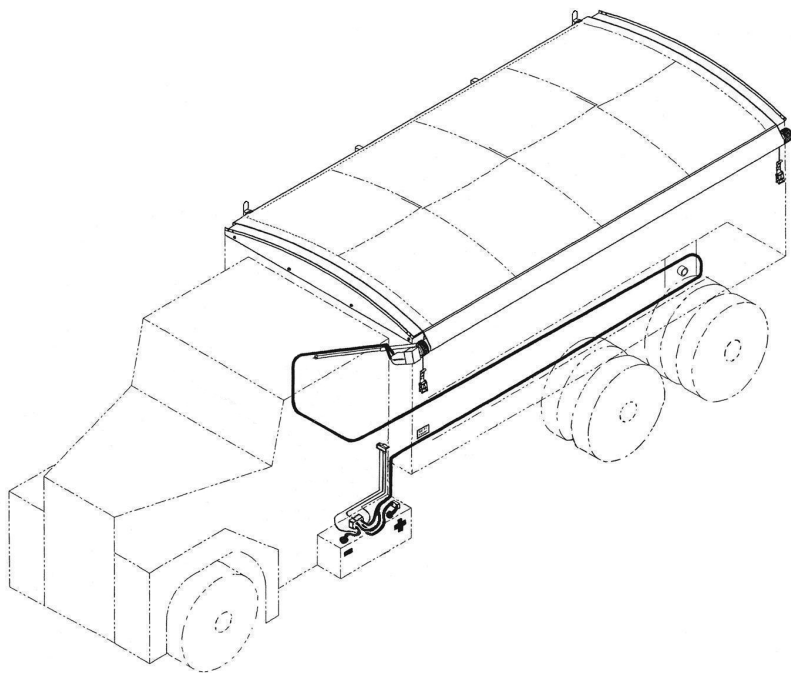

Special Instructions for Hardware Kit #70476

NOTE TO OWNER AND INSTALLER:

This switch kit contains replacement rocker switch, solenoid and electrical wire for electric roll tarps. Always disconnect power source before installing these components. If existing system does not have an automatic breaker, it is recommended one be purchased (40 Amp) and installed with this kit.

INSTALLER: These instructions must be given to the consumer.

CONSUMER: Save this manual for future reference.

READ AND FOLLOW THESE INSTRUCTIONS CAREFULLY BEFORE INSTALLING.

Actual parts may vary from those shown in this booklet.

PREPARATION

TOOLS NEEDED

Drill with 11/16" drill bit
#2 and #3 Phillips driver bit
7/16", 3/8", and #10 metric combination wrench
Heat gun
Protective eyewear

1: INSTALLATION PROCESS

A. Route heavy gauge wire from truck battery to tarp motor (cover diagram). For motor connection, split wires enough to allow stripping off insulation about 5/8" back. Slide heat shrink tube over wire, then push 1/4" ring terminal onto wire and crimp. Slide heat shrink tube over crimped terminal and heat to shrink.

B. Attach red wire to terminal 2 on motor.
Attach black wire to terminal 1 on motor.

NOTE: Always hold base nut on motor while tightening top nut.

C. Select suitable location in cab to mount switch bracket, using (2) #14 x 1" self drilling screws through slots in back wall of bracket.

D. Route 14 gauge wire from switch to solenoid at battery. Rubber grommet is supplied for area where wire goes through cab. Drill 11/16" hole for grommet.

E. For switch connection, strip 14 gauge wire ends about 3/8" back, attach push-on connectors and crimp. Pull wires through mount bracket and attach to switch as shown in illustration above. Push switch into mount bracket until it snap-locks in place.

F. Mount solenoid in protected area near battery using (2) #2 x 1" self drilling Phillips screws.

G. Prepare solenoid end of green 14 gauge wire with 1/4" ring terminal.

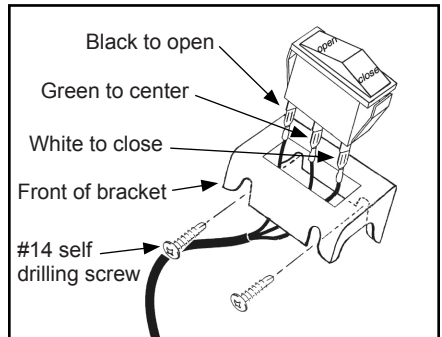
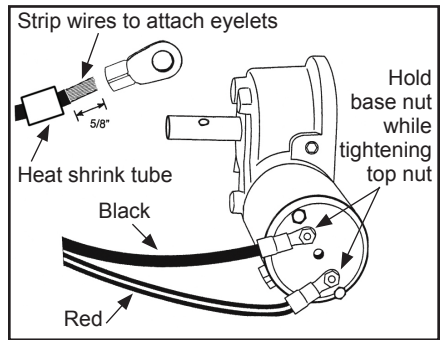

H. Prepare ends of heavy gauge wire at solenoid with (4) 1/4" heavy gauge ring terminals, heat shrink tubes and rubber boots.

I. Attach respective wires to solenoid terminal as shown. Note the jump wire leads through rubber boot with black negative (-) wire from battery. The green 14 gauge wire from switch leads through rubber boot with red positive (+) wire from battery (illustration below). When attaching ring terminals to solenoid, always hold base nut while tightening top nut.

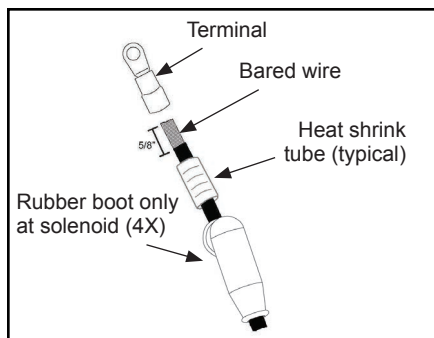

J. Prepare solenoid ends of black and white 14 gauge wires with push-on connectors. Connect white wire to left terminal on solenoid. Connect black wire to right terminal on solenoid (illustration below and wire schematic on back page).

NOTE: Do not over tighten.

K. Install circuit breaker in line on red positive (+) wire close to battery.

L. Prepare end of heavy gauge black wire for battery negative (-) post with heat shrink tube and 3/8" terminal ring. Prepare end of heavy gauge red wire for battery positive (+) post with heat shrink tube and 1/2" terminal ring.

M. First, attach red wire to battery positive (+) post. Then attach black wire to battery negative (-) post. Check system power. If switch runs system backwards, reverse 14 gauge wires at solenoid or switch.

NOTE: Check location of all wires to make sure they will not be pinched or cut during operation.

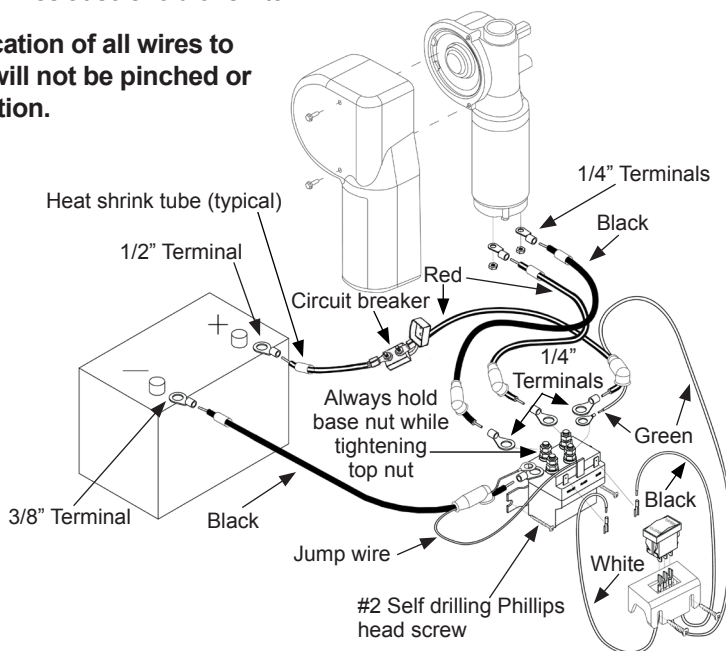

WIRE SCHEMATIC DIAGRAM

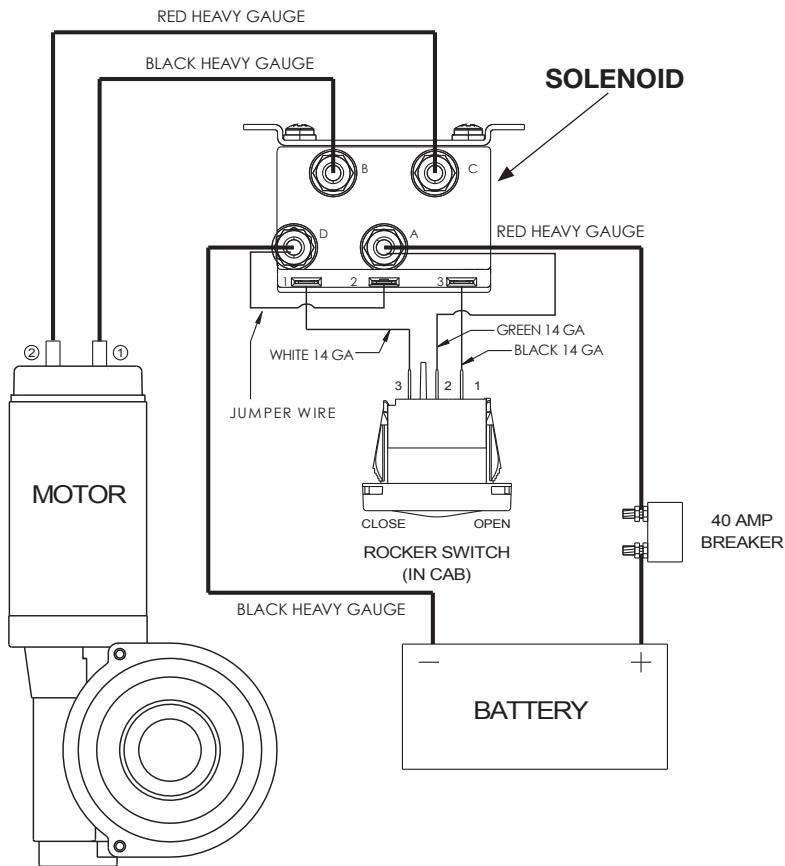

PARTS LIST

| QTY. | Part # | Description |
|--------|--------|--|
| 2 | 10914 | Screw, Self Drilling Phillips Head #14 x 1" Zinc Plated |
| 1 | 40649 | Rocker Switch 12V |
| 120 in | 40653 | Wire, 3 Conductor 14 Ga. (requires 10 lin. ft. from switch to cab) (price per lin. inch) |
| 1 | 40664 | 7/16" ID Rubber Grommet (for 14 ga. wire through cab) |
| 1 | 40673 | Switch Mounting Bracket |
| 1 | 40681 | Instructions, Electric Kit, Rocker Switch |
| 4 | 50996 | Eyelet Terminal Ring 6 Ga. 1/4" for Solenoid |
| 4 | 70278 | Terminal Boots, Lug Type 8 - 2 Ga. |
| 2 | 70298 | Screw, Self Drilling Phillips Head #10 x 1" |
| 5 | 70428 | Terminal, Female Push on 14 Ga. |
| 1 | 70446 | Eyelet Terminal Ring 14 Ga. 1/4" for Solenoid |
| 1 | 70498 | Solenoid, Motor Reversing 12V w/ Jump Wire |
| 1 | 70491 | Wire ASM, Jumper |