

GEARBOX UPDATE KIT INSTRUCTIONS

Use these instructions to update your gearbox.

NOTICE TO INSTALLER: Even if familiar with product, read instructions prior to installation as improvements may be made without notice. Always handle components with care. When done, these instructions must be given to the consumer.

NOTICE TO CONSUMER: Before using this product, read instructions. Save these instructions for future reference.

PREPARATION

TOOLS NEEDED

- Needle nose pliers
- Protective eyewear
- In-lb torque wrench with 3/16" Allen bit
- Ft-lb torque wrench
- Ratchet with 5/16", 7/16" and 1/2" socket
- 7/16" Wrench
- Loctite

▲ CAUTION: Over torquing hardware may damage components.

NOTE: Hardware appearance and components may vary.

▲ CAUTION: To avoid galling of stainless steel hardware, use anti-galling spray, grease or lubricant on threads and avoid high speed when fastening. Do not use impact tools for stainless steel hardware.

SAFETY INFORMATION

Do not install or use this product without reading and understanding these instructions. Only allow people who know and understand the safety rules to use this system.

▲ DANGER: Mounting replacement tarp to a structurally weak or damaged roll tube can result in serious injury or death.

IMPORTANT: When performing maintenance procedures on spring arms, note arms are under spring pressure. Always use caution and assistance from another person if disassembly is required.

- Be aware that front and rear arms move during operation. Ensure people and objects are clear of tarp system before and during operation.
- Do not use front or rear arms as a step.
- Always use caution when operating tarp system.
- Never allow children to operate or play with tarp system.
- Disconnect power before servicing tarp system or electrical components.
- Ensure tarp is fully open before unloading or loading.
- Ensure nobody is on or near tarp system before and during operation.
- Do not operate tarp with box hoisted in elevated position.
- Remove snow or debris from top of tarp system before operating.
- End caps must be free from commodity. Commodity should not be piled higher than end caps.
- Ensure tarp system is fully open or fully closed before operating vehicle at highway speeds.
- Instruct everyone who will operate this tarp on the proper procedures.
- Do not directly spray motor or connections with a pressure washer.
- Always refer to OEM instructions before installing electrical components.

PARTS DIAGRAM

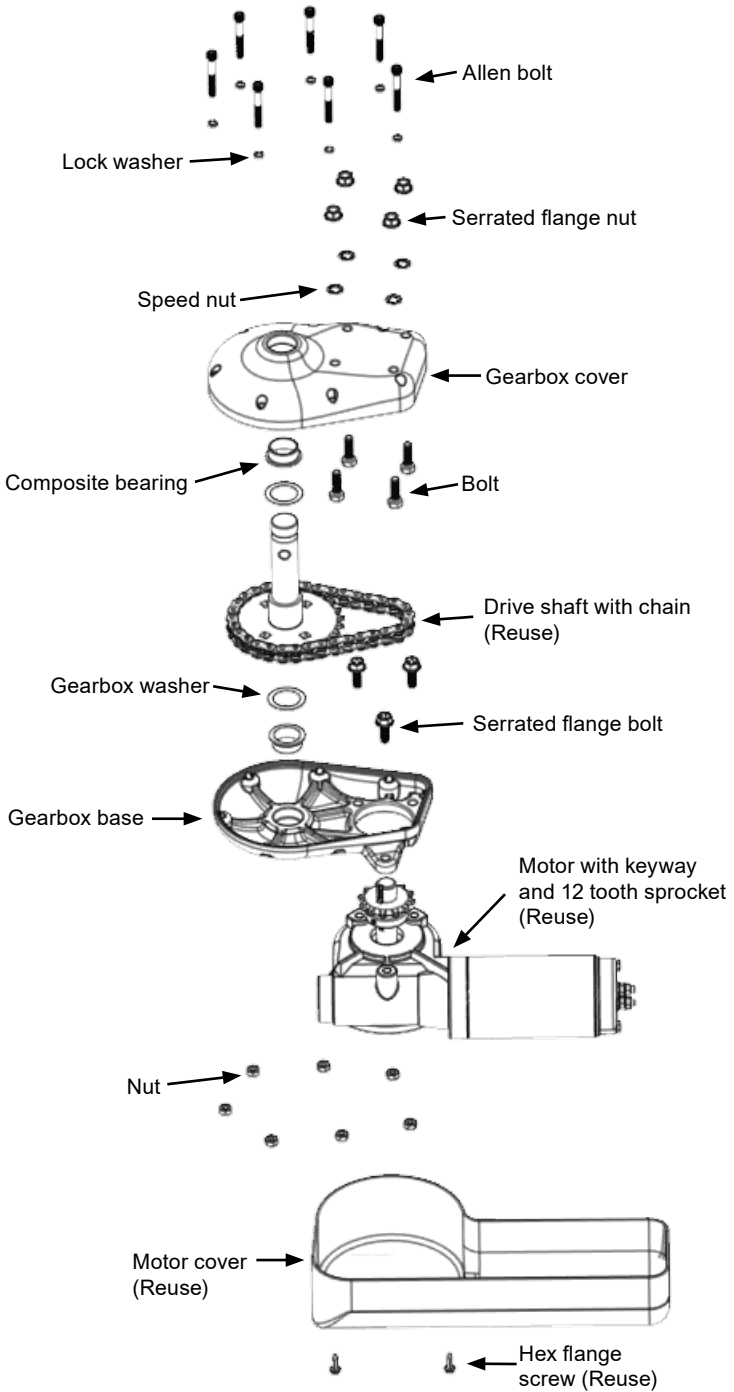

1: INSTALL GEARBOX UPDATE

IMPORTANT: Disconnect power source before removing gearbox.

A. Remove wires from motor terminals. Disconnect and remove gearbox from cartridge in roll tube, then remove gearbox from front arm.

B. Disassemble gearbox, ensuring not to move the 12 tooth sprocket and keyway attached to motor. Save motor, drive shaft, chain, motor cover and hex flange screws for reassembly.

C. Press composite bearings into gearbox base and cover.

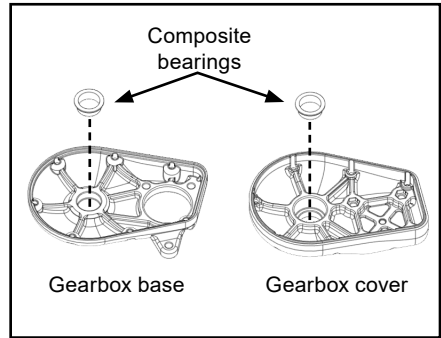
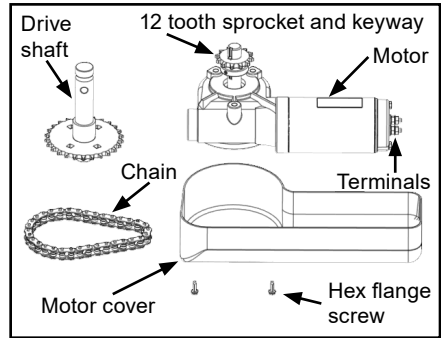

D. Press (6) nuts into gearbox base.

NOTE: 7th nut will be installed in Step 1K.

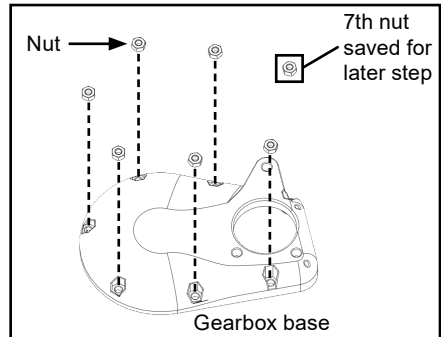

1: INSTALL GEARBOX UPDATE (Continued)

E. Press (4) bolts into gearbox cover. Place speed nuts on each bolt, then use 7/16" socket to fully seat speed nuts against gearbox cover.

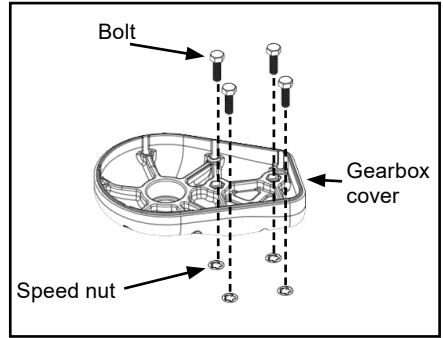

F. Place gearbox base on motor and align holes. Secure with serrated flange bolts, then torque to 18 ft-lbs.

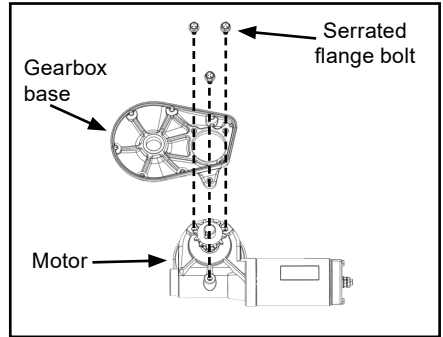

G. Slide (1) gearbox washer on drive shaft, then place other gearbox washer on composite bearing. Place drive shaft in composite bearing ensuring chain is secured to teeth on 12 tooth sprocket and drive shaft.

IMPORTANT: Lubricate chain.

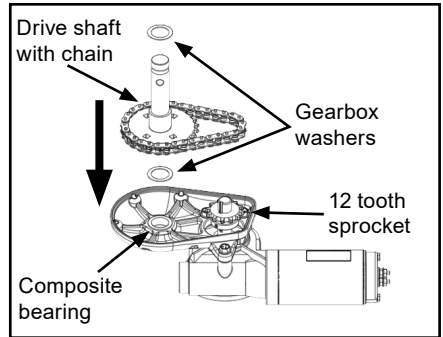

1: INSTALL GEARBOX UPDATE (Continued)

H. Slide gearbox cover onto drive shaft while aligning holes in gearbox cover and base.

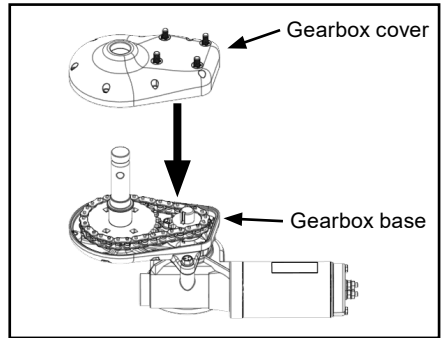

I. Place lock washer on Allen bolt and apply Loctite. Insert through gearbox cover and base, then thread into nut in base.

J. Repeat for remaining Allen bolt locations.

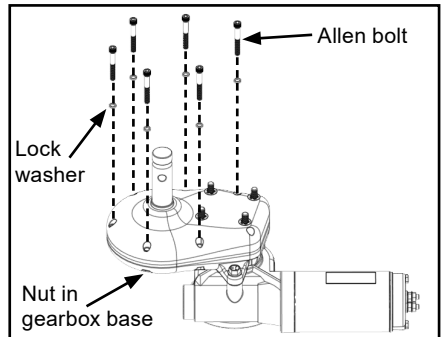

K. Slide nut left from Step 1D into final nut location on gearbox base, then place lock washer on Allen bolt and apply Loctite. Thread into nut in base.

L. Begin tightening bolts while working your way around gearbox. Torque Allen bolts to 37 in-lbs (3.1 ft-lbs).

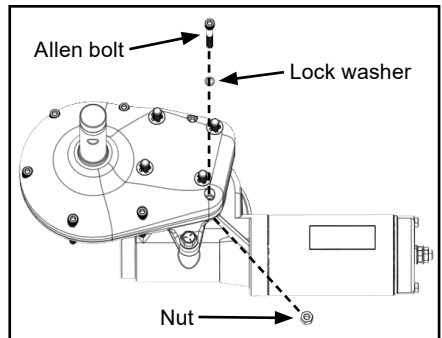

M. Attach wires to motor terminals, ensure to use 7/16" wrench to hold base nut while torquing to 42 in-lbs (3.5 ft-lbs). Align holes in motor cover and motor. Fully tighten hex flange screw.

N. Attach gearbox to front arm with serrated flange nuts, fully tighten. Reinstall gearbox to cartridge in roll tube.

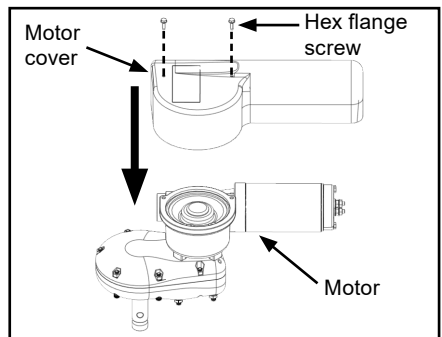

INSPECTION AND MAINTENANCE

▲ CAUTION: Some lubricants attract dust, avoid using on telescoping components.

IMPORTANT: Electric tarp system is equipped with a modified reset circuit breaker. Holding switch until circuit breaker trips is too long. When this occurs, breaker will trip and reset if the breaker is overloaded by the motor. To reduce unnecessary strain on components, always release switch before breaker trips. If breaker trips and does not reset, it may have detected a continuous short and will not reset until the short is repaired.

- Periodic preventive maintenance should be practiced. Inspect tarp system often for proper operation.
- Inspect tarp and hardware for abrasions or loosened bolts that may need adjustment. Adjust tension when needed. Tarp must be kept to a recommended tension setting equally on both ends, or excessive tarp wear may occur.
- Tarp should always operate as well as when first installed. Make all appropriate repairs or adjustments immediately before serious damage occurs.
- Periodically inspect front arm (and spiral springs) for loose or worn parts and replace as needed. Clean telescoping parts for smooth operation.
- Periodically check the tightness of mounting bolts and electrical connections. Remove any dirt or corrosion that may have accumulated on the electrical connections.
- Periodically grease zerk fittings.
- Always use genuine Agri-Cover, Inc. replacement parts if repairs are needed.

TROUBLESHOOTING

PROBLEM

Arm lifts off trailer during operation.

SOLUTION

Check install height.

Check for debris or obstructions.

Check bearings.

Check for twist in wire in upper arm.

