

# ROLL UP TRUCK BOX COVER SPECIAL CLAMP AND SEAL INSTRUCTIONS

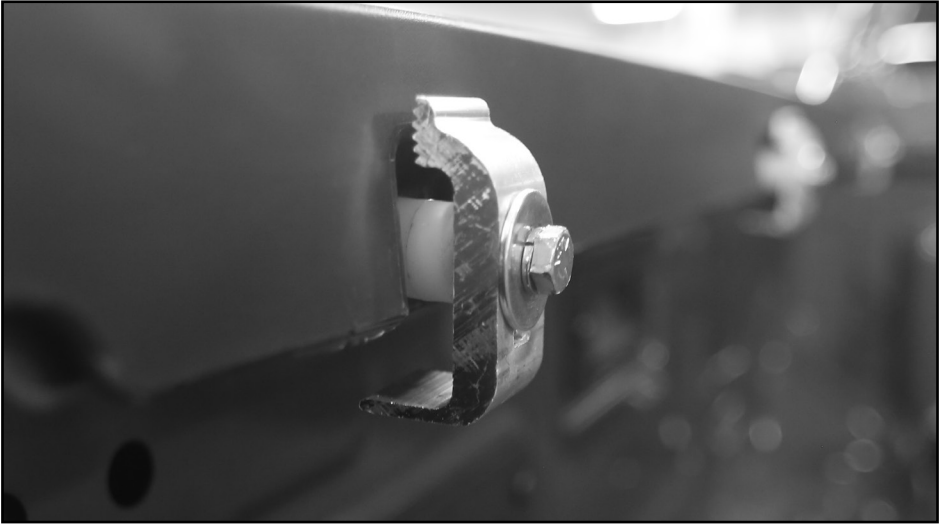

## 2024-ON FORD RANGER

Read and follow these special instructions along with the standard instructions carefully before installing or using this cover.

**NOTICE TO INSTALLER:** Even if familiar with product, read special instructions prior to installation as improvements may be made without notice. Always handle components with care. When done, these special instructions must be given to the consumer.

**NOTICE TO CONSUMER:** Before using this product, read special instructions. Save these special instructions for future reference.

# PREPARATION

## TOOLS NEEDED

- 7/16" Wrench
- Ratchet with 7/16" socket
- Ft-lb Torque wrench
- Body panel tool or flathead screwdriver
- Scissors
- Protective eyewear

**⚠ CAUTION:** Over torquing hardware may damage components.

**NOTE:** Hardware appearance and components may vary.

**⚠ CAUTION:** Always cut away from yourself and others.

## 1: INSTALLING SIDE RAILS

A. Starting at front of box, remove 1<sup>st</sup>, 2<sup>nd</sup> and 4<sup>th</sup> body panel clips from bed cap using body panel tool.

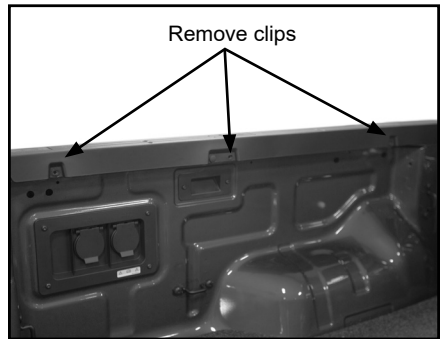

B. Orientation of clamp hardware.

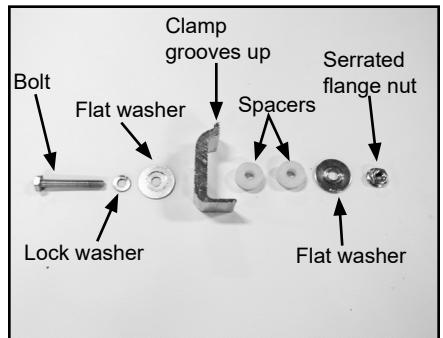

# 1: INSTALLING SIDE RAILS (Continued)

C. Insert clamp assemblies into bed cap with clamp grooves up, place flat washer on back side of bolt and loosely tighten serrated flange nut.

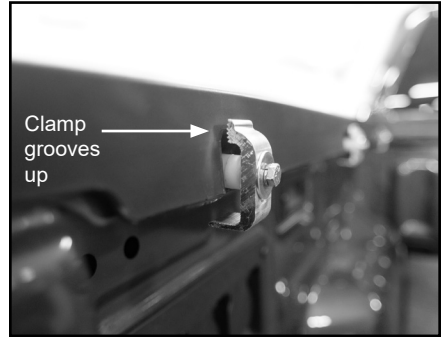

D. Place rail between clamps and inside of box, then slide forward until end of rail is flush with bulkhead.

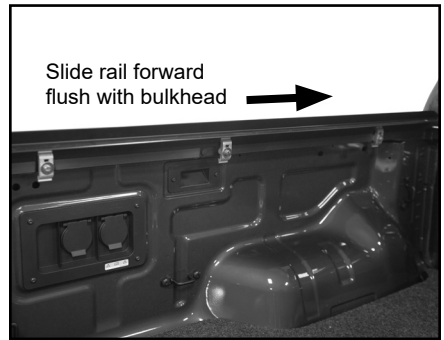

E. Use standard instructions to determine correct height and position of side rail.

F. Ensure side rail is level, starting at the front tighten all bolts.

G. Torque all bolts to 10 ft-lbs.

**NOTE:** If clamps don't fully engage side rail, remove one spacer per clamp.

H. Repeat on opposite side.

## 2: APPLYING FRONT SEAL

**NOTE:** For best adhesion, ensure air and surface temperatures are above 60° F.

**NOTE:** With a spray-in bed liner, better adhesion is possible by smoothing surface and applying an adhesion promoter.

A. Ensure bulkhead is clean, wipe top surface with alcohol pad.

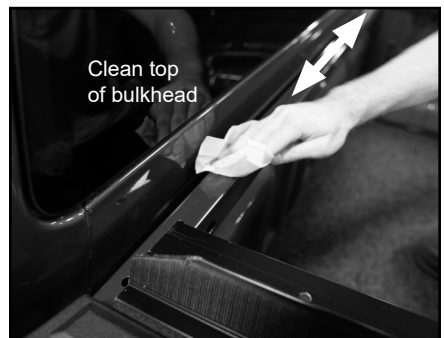

## 2: APPLYING FRONT SEAL (Continued)

Perform one of the following to install front seal:

### 2024-2025 MODELS

- A. Starting at one end, peel protective backing as you go. Align and adhere seal gasket against front of side rail and inside edge of box to opposite corner and cut to length.
- B. Firmly press adhesive along seal.



### 2026-ON MODELS

**IMPORTANT: Ensure raised portion of seal is against inside edge of box while unraised portion is toward cab.**

- A. Starting at one end, peel protective backing as you go. Align and adhere seal against front of side rail and inside edge of box to opposite corner and cut to length.
- B. Firmly press adhesive along seal.

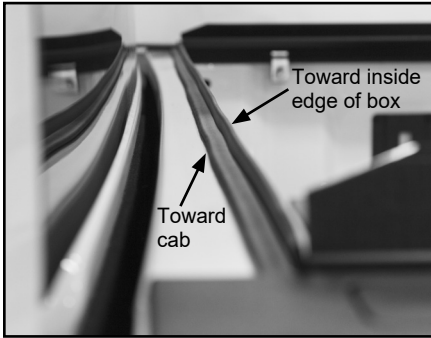

### ALL MODELS

**IMPORTANT: Pull vinyl flap out for this application.**

- C. For remaining installation, refer to standard instructions.

