

TRUCK BED RACK SPECIAL UTILITY RAIL INSTRUCTIONS



2022-ON FORD MAVERICK

Read and follow these special instructions along with the standard instructions carefully before installing truck bed rack or rails.

NOTICE TO INSTALLER: Even if familiar with product, read instructions prior to installation as improvements may be made without notice. Always handle components with care. When done, these instructions must be given to the consumer.

NOTICE TO CONSUMER: Before using this product, read these instructions. Save these instructions for future reference.

PREPARATION

TOOLS NEEDED

- Protective eyewear
- Drill with 13/32" bit
- Ratchet with 9/16", 8mm and 10mm socket
- In-lb torque wrench
- Tape
- Cutting tool

NOTE: Hardware appearance and components may vary.

⚠ CAUTION: Over torquing hardware may damage components.

⚠ CAUTION: Always cut away from yourself and others.

1: PREPARING RAILS

A. Refer to Step 1 in the standard instructions to prepare rails.

2: PREPARING BED CAP

A. Starting at the back, gently lift on bed cap working your way forward to remove.



B. Remove (2) connectors from rear of bed cap.

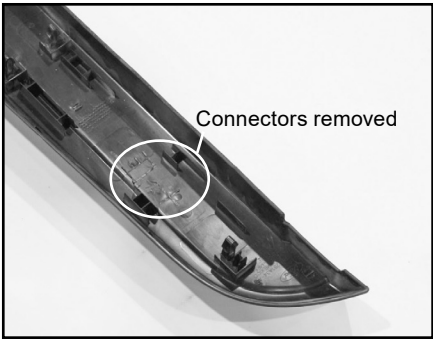
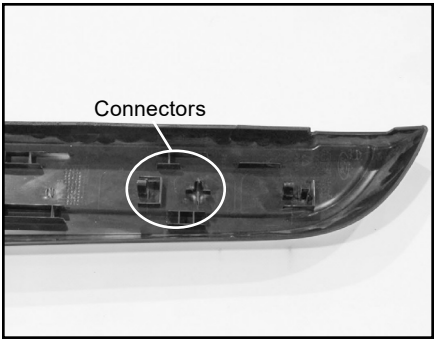

2: PREPARING BED CAP (Continued)

C. Remove front two bolts from bed rail.

NOTE: Factory bolts will not be reinstalled. Installer should return factory bolts to owner.

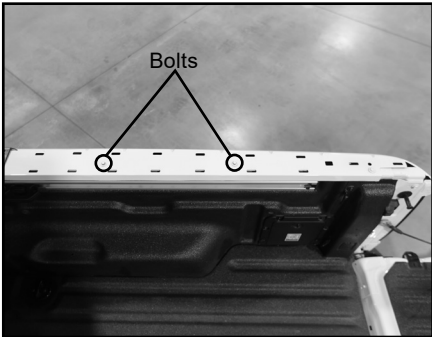

D. With wider end of spacer plate towards cab and holes favoring outside of box, align spacer plate with (3) holes on bed rail. Tape spacer plate down for ease of installation.

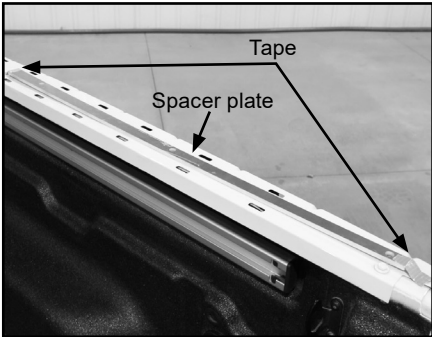

E. Reinstall bed cap, ensuring to leave 1/4" gap at front of bed cap. Place drill guide on bed cap and align outside edge of drill guide to inside ridge of bed cap, ensuring radius of both drill guide and bed cap align. Tape drill guide down for ease of installation.

IMPORTANT: Ensure 1/4" gap at front of bed cap or drill guide holes may be misaligned.

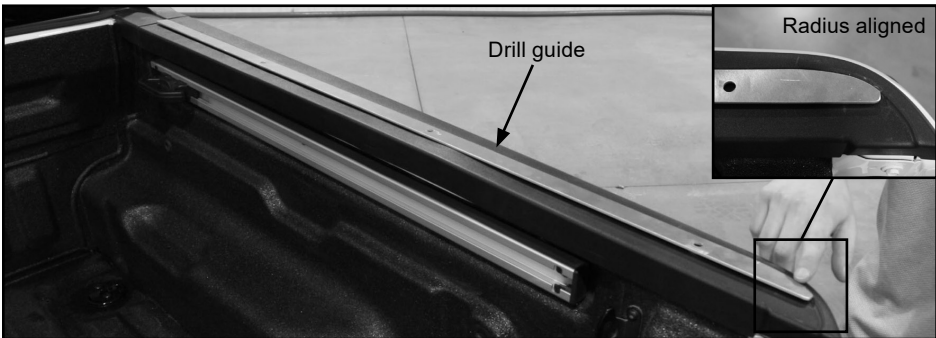
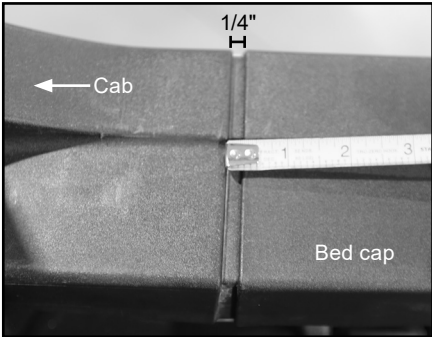

2: PREPARING BED CAP (Continued)

F. Using drill guide as a template, drill (3) 13/32" holes through bed cap only.

G. Align holes in rail with holes drilled in bed cap.

H. Place lock washer and flat washer on (2) M6 bolts. Starting at the front, install bolts through rail, drill guide, bed cap and spacer plate into factory weld nuts.

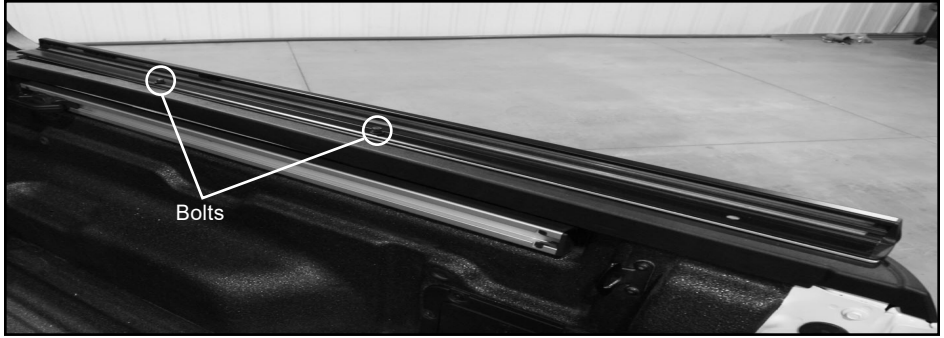

I. Remove rear taillight assembly and place clamp plate underneath rear hole drilled in bed cap with extended threads towards cab.

IMPORTANT: Ensure extended threads on clamp plate are toward box floor.

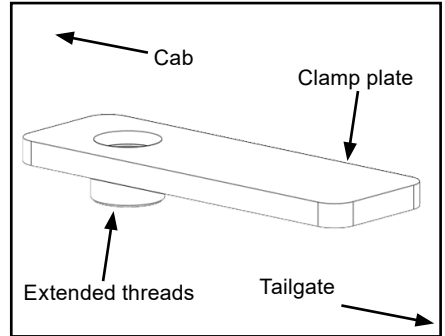

J. Place flat washer on 3/8" bolt and insert through rail, drill guide, bed cap and spacer plate, then thread into clamp plate. Fully tighten bolt.

K. Reinstall taillight assembly, then remove tape securing drill guide.

L. Torque (2) M6 bolts to 100 in-lbs (8.4 ft-lbs).

M. Repeat for opposite side.

