



INSTALLATION INSTRUCTIONS

Thank you for purchasing SRT-2™ Electric Tar Conversion. Agri-Cover, Inc. proudly manufactured this tarp using superior quality materials and workmanship. With proper care, your tarp will provide years of service.

NOTICE TO INSTALLER: Even if familiar with product, read instructions prior to installation as improvements may be made without notice. Always handle components with care. If you have questions or problems, have serial number ready and call customer service. When done, these instructions must be given to the consumer.

NOTICE TO CONSUMER: Before using this product, read operating, maintenance and safety sections. Save these instructions for future reference.

FOR YOUR RECORDS

DATE PURCHASED: _____

WHERE PURCHASED: _____

TARP SERIAL NUMBER: _____

(Located on motor and gearbox)



Questions? (800) 233-4655
agricover.com

PREPARATION

- Prior to tarp system assembly, park truck or trailer on level ground.
- Box must be square and straight, center must not be pulled together or spread apart.
- Remove or grind smooth any sharp edges or points contacting tarp and/or cables.
- Remove or reposition any interferences with motor. If modifications to box are needed, consult box manufacturer.
- Ensure box extension is secure by bolting in place on top of your box.

TOOLS NEEDED

- (2) 1/2" Wrenches
- Step ladders or scaffolding
- Drill with 5/16" and 3/8" bits
- Protective eyewear
- Cutting tool(s)
- Marking pencil
- 9/16" Wrench
- Tape measure

NOTE: Hardware appearance and components may vary.

▲ CAUTION: Before drilling, ensure there are no hidden wires or gussets in line with holes to be drilled.

STAINLESS STEEL HARDWARE ONLY

▲ CAUTION: To avoid galling of stainless steel hardware, use anti-galling spray, grease or lubricant on threads and avoid high speed when fastening. Do not use impact tools for stainless steel hardware.

A. Turn 3/8" x 1" non-stainless steel self-threading bolt in 5/16" hole to cut threads, then turn back out.

B. Turn 3/8" x 1" stainless steel bolt in for attachment. When possible, use stainless steel nuts and washers with these bolts.

SAFETY INFORMATION

Do not install or use this product without reading and understanding these instructions. Only allow people who know and understand the safety rules to use this system.

▲ DANGER: Mounting replacement tarp to a structurally weak or damaged roll tube can result in serious injury or death.

Before installing replacement tarp, inspect mounting surface of roll tube. Be aware several mounting holes in close proximity may compromise roll tube strength and integrity. Ensure mounting location on roll tube provides adequate tarp support.

- Disconnect power before servicing tarp system or electrical components.
- Always use caution when operating tarp system.
- Ensure people and objects are clear of tarp system before and during operation.
- Instruct everyone who will operate tarp system on the proper procedures.
- Never allow children to operate or play with tarp system.
- Do not operate tarp system with box hoisted in elevated position.
- Ensure tarp system is fully open or fully closed before operating vehicle at highway speeds.
- Only operate tarp system when tarp is completely visible.
- Always refer to OEM instructions before installing electrical components.
- Do not use arm as a step.
- Remove snow or debris from top of tarp system before operating.
- End caps must be free from commodity. Commodity should not be piled higher than end caps.
- Do not directly spray motor or connections with a pressure washer.
- Ensure tarp system is fully open before unloading or loading.

NOTE: Safety and operating procedure decals provided with this kit should be kept clean at all times and replaced if worn, damaged, painted over or unreadable.

1: ATTACHING MOTOR

- A. Place and weld motor mount slide frame to center of belly dump's cross frame.
- B. Mount motor to motor mount carriage with (3) 5/16" x 3/4" hex bolts and washers.
- C. Slide motor on motor mount slide frame with motor facing front of trailer.
- D. Attach dual pole mounting plate to motor mount slide frame using (2) 5/16" x 2" bolts, washers and nylon nuts.
- E. Attach drive shaft with U-joint to motor drive shaft.
- F. Ensure motor is 1-1/2" from back of motor mount slide frame.

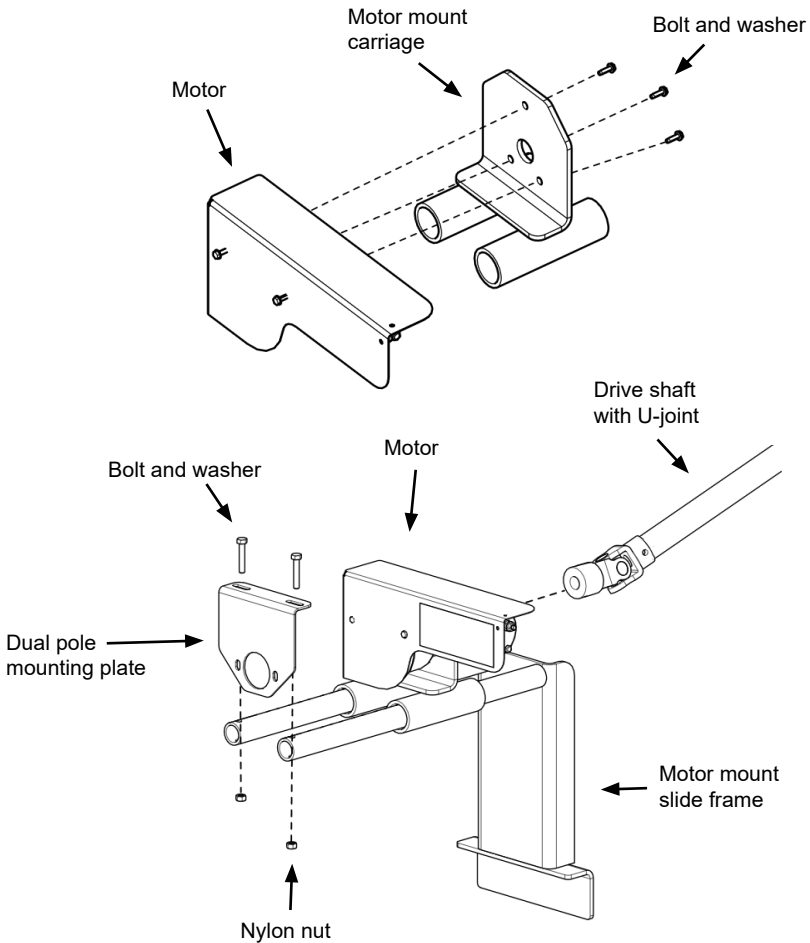

2: INSTALLING U-JOINT

A. Temporarily attach U-joint with extension to drive shaft using cotter and clevis pins. Do not bend cotter pin tabs.

B. Remove clevis and cotter pins holding spacer on cartridge protruding from spool. Slide U-joint with extension into spacer and cartridge.

C. Test for clearance then secure U-joint with extension to drive shaft with clevis and cotter pins.

NOTE: If necessary, cut drive shaft to length then drill $5/16"$ hole using hole in U-joint with extension as guide.

D. Use hole in end of spacer and cartridge as guide to drill a $5/16"$ hole in U-joint extension, then secure with clevis and cotter pins. Bend all cotter pin tabs.

TIP: Periodically grease motor drive shaft and extension.

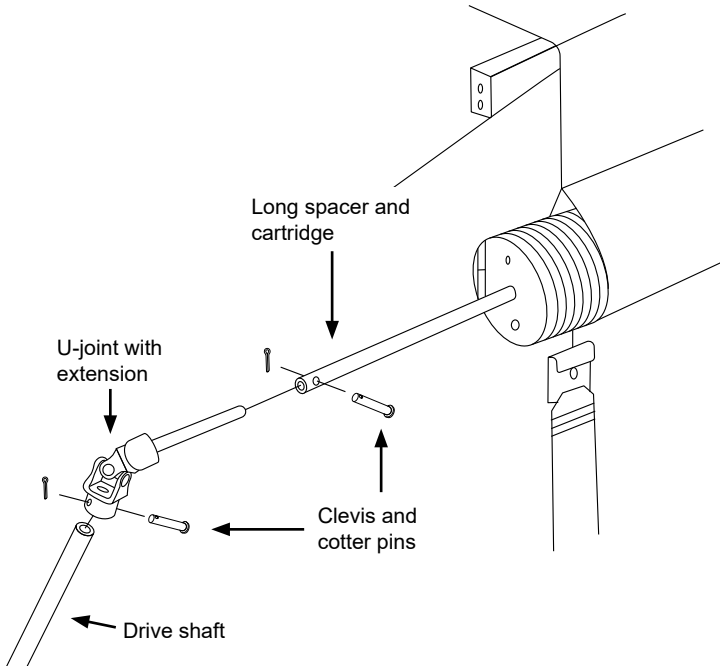

3: ELECTRICAL

- A. Locate and clean suitable locations to apply caution stickers.
- B. Refer to included instructions to complete wiring.

4: INSTALLING CONNECTOR SOCKET

- A. Bolt connector socket to dual pole mounting plate using (2) 5/16" x 1" bolts, flat washers, lock washers and nuts.

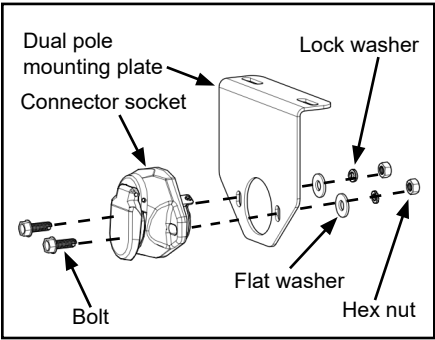

INSPECTION AND MAINTENANCE

Periodic preventive maintenance should be practiced:

- Inspect tarp and hardware for abrasions or loosened bolts that may need adjustment. Adjust tension when needed. Tarp must be kept to a recommended tension setting equally on both ends, or excessive tarp wear may occur.
- Tarp should always operate as well as when first installed. Make all appropriate repairs or adjustments immediately before serious damage occurs.
- Check the tightness of mounting bolts and electrical connections, remove any dirt or corrosion that may have accumulated on the electrical connections.
- Always use genuine Agri-Cover, Inc. replacement parts, use serial number to easily order replacement tarp.

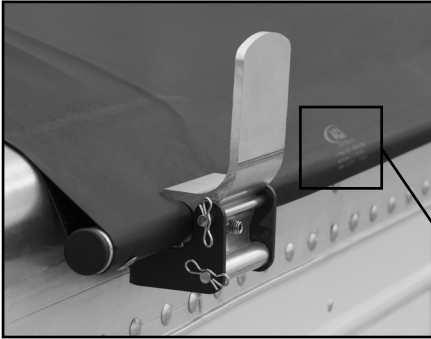

Serial number is located at rear
of tarp on stationary tube side



For Replacement: 1-800-233-4655
EZL/ATL Part #: KA-116132A010
SERIAL: 123456789 18.12.2015

MANUFACTURER'S LIMITED WARRANTY

Agri-Cover, Inc. extends the following Limited Warranty on its SRT-2™ Electric Tarp Conversion:

Agri-Cover, Inc. warrants its SRT-2™ Electric Tarp Conversion to be free from defects in material and workmanship under normal use for one (1) year from date of manufacture unless accompanied by proof of purchase. The one (1) year warranty start date can be found on the unit (motor and gearbox). Check both and refer to the oldest date shown. This Limited Warranty does not cover any failure due to abuse, misuse, alteration, neglect, improper assembly or installation, or improper maintenance.

ANY IMPLIED WARRANTY APPLICABLE TO THE SRT-2™ ELECTRIC TARP CONVERSION IS LIMITED IN DURATION TO ONE YEAR FROM THE DATE OF MANUFACTURE UNLESS ACCOMPANIED BY PROOF OF PURCHASE. Agri-Cover Inc.'s sole obligation under this Limited Warranty or any implied warranty is limited to the repair or replacement at its option, of defective parts only. No labor or service allowance is given or implied. IN NO EVENT SHALL AGRI-COVER, INC. BE LIABLE FOR INCIDENTAL, CONSEQUENTIAL, OR SPECIAL DAMAGES. EXPRESSLY DISCLAIMS ANY AND ALL IMPLIED WARRANTIES OF MERCHANTABILITY, AND THERE ARE NO WARRANTIES WHICH EXTEND BEYOND THE LIMITED WARRANTY DESCRIPTION CONTAINED HEREIN.

For warranty, have serial number ready and fill out the warranty claim form at agricover.com/warrantyclaim or call Customer Service Department at 800-233-4655 to determine if only a replacement part is needed or if the tarp needs to be returned for inspection and repair. Goods to be returned must have a pre-authorized RA # (Return Authorization Number) – obtained by calling the number above. Mark the number on the package and ship it freight prepaid to address below. Agri-Cover will pay freight to return goods to sender.

This Limited Warranty gives you specific legal rights and you may have other rights, which vary, from state to state.

For replacement parts shop at agricoverparts.com or call Customer Service at 800-233-4655.



Agri-Cover, Inc.
Customer Service Dept
3000 Hwy 281 SE
Jamestown, ND 58401
Phone: 800-233-4655

Hours: 8:00 am - 5:00 pm CST Monday through Friday, except Holidays