



INSTALLATION INSTRUCTIONS

Thank you for purchasing SRT-2™ Electric Tarap Conversion. Agri-Cover, Inc. proudly manufactured this tarap using superior quality materials and workmanship. With proper care, your tarap will provide years of service.

NOTICE TO INSTALLER: Even if familiar with product, read instructions prior to installation as improvements may be made without notice. Always handle components with care. If you have questions or problems, have serial numbers ready and call customer service. When done, these instructions must be given to the consumer.

NOTICE TO CONSUMER: Before using this product, read operating, maintenance and safety sections. Save these instructions for future reference.

FOR YOUR RECORDS

DATE PURCHASED: _____

WHERE PURCHASED: _____

TARP SERIAL NUMBER: _____

(Located on motor and gearbox)



Questions? (800) 233-4655
agricover.com

PREPARATION

- Prior to tarp system assembly, park truck or trailer on level ground.
- Box must be square and straight, center must not be pulled together or spread apart.
- Remove or grind smooth any sharp edges or points contacting tarp and/or cables.
- Remove or reposition any interferences with motor. If modifications to box are needed, consult box manufacturer.
- Ensure box extension is secure by bolting in place on top of your box.

TOOLS NEEDED

- (2) 1/2" Wrenches
- 9/16" Wrench
- Step ladders or scaffolding
- Drill with 5/16" and 3/8" bits
- Tape measure
- Hammer
- Protective eyewear
- Cutting tool
- Marking pencil

NOTE: Hardware appearance and components may vary.

▲ CAUTION: Before drilling, ensure there are no hidden wires or gussets in line with holes to be drilled.

STAINLESS STEEL HARDWARE ONLY

▲ CAUTION: To avoid galling of stainless steel hardware, use anti-galling spray, grease or lubricant on threads and avoid high speed when fastening. Do not use impact tools for stainless steel hardware.

A. Turn 3/8" x 1" non-stainless steel self-threading bolt in 5/16" hole to cut threads, then turn back out.

B. Turn 3/8" x 1" stainless steel bolt in for attachment. When possible, use stainless steel nuts and washers with these bolts.

SAFETY INFORMATION

Do not install or use this product without reading and understanding these instructions. Only allow people who know and understand the safety rules to use this system.

▲ DANGER: Mounting replacement tarp to a structurally weak or damaged roll tube can result in serious injury or death.

Before installing replacement tarp, inspect mounting surface of roll tube. Be aware several mounting holes in close proximity may compromise roll tube strength and integrity. Ensure mounting location on roll tube provides adequate tarp support.

- Disconnect power before servicing system or electrical components.
- Always use caution when operating tarp.
- Ensure people and objects are clear of tarp system before and during operation.
- Instruct everyone who will operate this tarp on the proper procedures.
- Never allow children to operate or play with system.
- Do not operate tarp with box hoisted in elevated position.
- Ensure tarp system is fully open or fully closed before operating vehicle at highway speeds.
- Only operate system when tarp is completely visible.
- Always refer to OEM instructions before installing electrical components.
- Do not use arm as a step.
- Remove snow or debris from top of tarp before operating.
- End caps must be free from commodity. Commodity should not be piled higher than end caps.
- Do not directly spray motor or connections with a pressure washer.
- Ensure tarp is fully open before unloading or loading.

NOTE: Safety and operating procedure decals provided with this kit should be kept clean at all times and replaced if worn, damaged, painted over or unreadable.

1: MOUNTING LOWER PIVOT ARM

NOTE: For stainless steel see page 2 for bolting procedures.

A. At front of trailer, align center point of pivot bolt with centerline of box. Measure down about 36" from top of end cap and mark holes.

NOTE: Pivot bolt can be mounted higher or at rear of box. If mounting pivot bolt higher, top pivot arm must be cut shorter. **DO NOT CUT SHORTER THAN 10"**.

IMPORTANT: Before drilling, ensure arm has a clear path to operate.

- A. Drill a 3/8" hole through box wall. From inside of box, insert pivot bolt through hole with lock washer and flat washer. Then tighten with flat washer and nut on outside.
- B. Turn a nylock nut on pivot bolt, followed by lower pivot arm and secure with additional nylock nut.
- C. Tap nylon plug into top of lower pivot arm.
- D. Square pivot arm with roll tube by adjusting location of two nylock nuts and pivot arm as necessary.

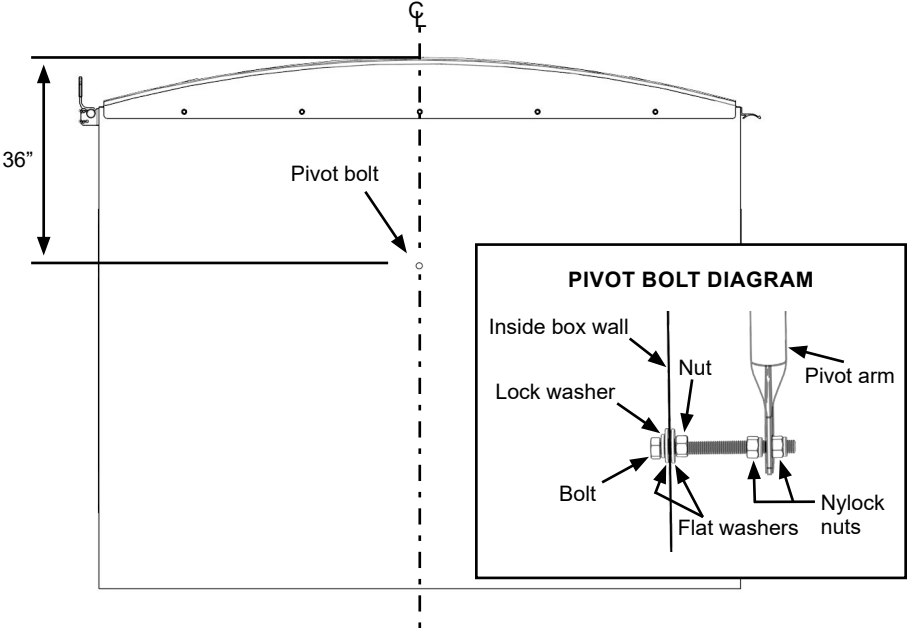

2: ATTACHING MOTOR

Perform one of the following to attach motor:

NOTE: For stainless steel see page 2 for bolting procedures.

15" CARTRIDGE

A. Remove clevis and cotter pins holding spacer on end of roll tube. Slide motor extension into cartridge and spacer.

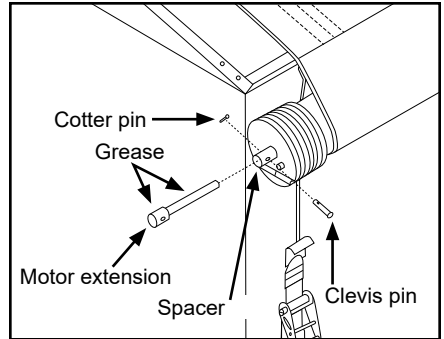

B. Secure motor to upper pivot arm mount using (3) 5/16" x 3/4" bolts with lock washers.

C. Slide upper pivot arm with motor over top of lower pivot arm.

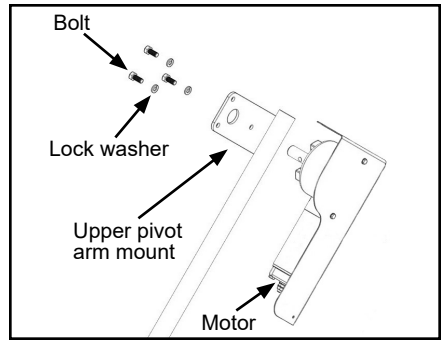

D. Insert drive shaft into motor extension. Turn roll tube by hand until holes align, then insert clevis and cotter pin.

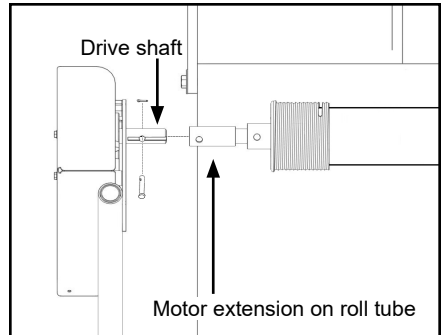

E. Square pivot arm with roll tube by adjusting motor extension forward or backward as needed.

IMPORTANT: Ensure path of motor arm is free of obstructions.

NOTE: If not installed square with roll tube and pivot mount, motor will bind and wobble during operation.

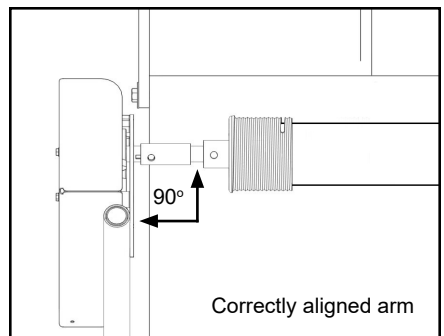

2: ATTACHING MOTOR (Continued)

F. Use hole in end of spacer and cartridge as guide to drill a 5/16" hole in motor extension then secure with clevis and cotter pins. Bend cotter pin tabs.

TIP: Periodically grease motor extension.

NOTE: If lower pivot arm extends past top of motor in closed position, trim off excess. Then reinsert nylon plug into top of lower pivot arm.

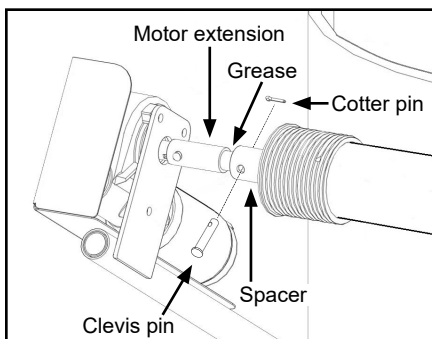

33" CARTRIDGE

A. Secure motor to upper pivot arm mount using (3) 5/16" x 3/4" bolts with lock washers.

B. Slide upper pivot arm with motor over top of lower pivot arm.

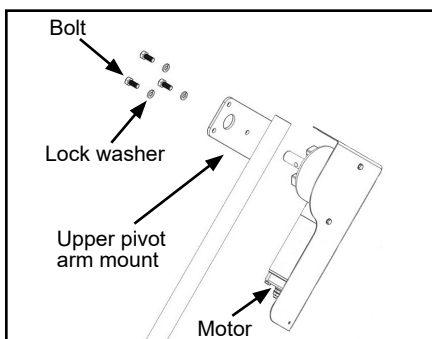

C. Lift motor and arm up to cartridge on roll tube then square motor with roll tube.

NOTE: If not installed square with roll tube and pivot mount, motor will bind and wobble during operation.

D. Mark spacer and cartridge 5/16" from upper pivot arm mount.

IMPORTANT: Ensure path of motor arm is free of obstructions.

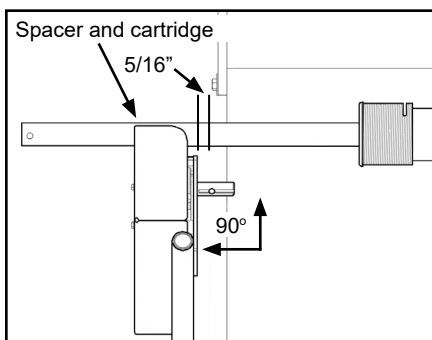

E. Cut cartridge and spacer at marked location. Remove clevis and cotter pins, save for later.

F. Make mark on spacer 1/2" in from end and drill pilot hole, then drill 5/16" hole through spacer and cartridge.

NOTE: Ensure to drill squarely through both parts.

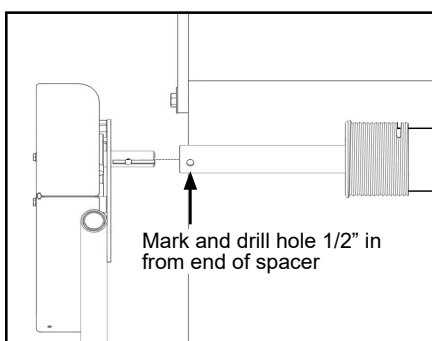

2: ATTACHING MOTOR (Continued)

G. Insert drive shaft on motor into cartridge.

H. Turn roll tube by hand until holes align and secure with previously removed clevis and cotter pins. Bend cotter pin tabs.

TIP: Periodically grease motor extension.

NOTE: If lower pivot arm extends past top of motor in closed position, trim off excess. Then reinsert nylon plug into top of lower pivot arm.

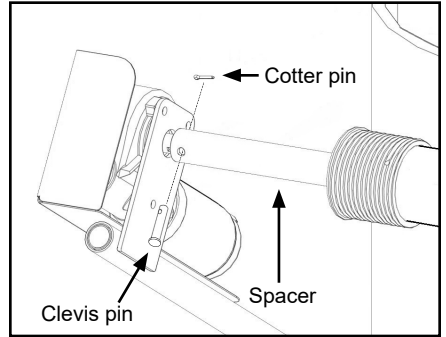

3: ELECTRICAL

A. Locate and clean suitable locations to apply caution stickers.

B. Refer to included instructions to complete wiring.

INSPECTION AND MAINTENANCE

Periodic preventive maintenance should be practiced:

- Inspect tarp and hardware for abrasions or loosened bolts that may need adjustment. Adjust tension when needed. Tarp must be kept to a recommended tension setting equally on both ends, or excessive tarp wear may occur.
- Tarp should always operate as well as when first installed. Make all appropriate repairs or adjustments immediately before serious damage occurs.
- Check the tightness of mounting bolts and electrical connections, remove any dirt or corrosion that may have accumulated on the electrical connections.
- Always use genuine Agri-Cover, Inc. replacement parts, use serial number to easily order replacement tarp.

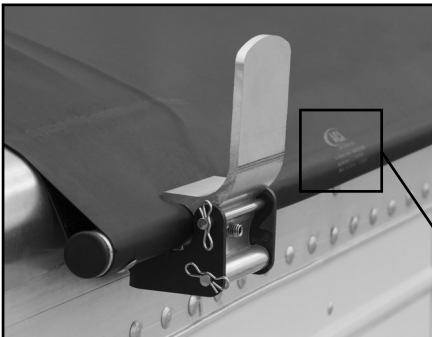

Serial number is located at rear of tarp on stationary tube side



MANUFACTURER'S LIMITED WARRANTY

Agri-Cover, Inc. extends the following Limited Warranty on its SRT-2™ Electric Tarp Conversion:

Agri-Cover, Inc. warrants its SRT-2™ Electric Tarp Conversion to be free from defects in material and workmanship under normal use for one (1) year from date of manufacture unless accompanied by proof of purchase. The one (1) year warranty start date can be found on the unit (motor and gearbox). Check both and refer to the oldest date shown. This Limited Warranty does not cover any failure due to abuse, misuse, alteration, neglect, improper assembly or installation, or improper maintenance.

ANY IMPLIED WARRANTY APPLICABLE TO THE SRT-2™ ELECTRIC TARP CONVERSION IS LIMITED IN DURATION TO ONE YEAR FROM THE DATE OF MANUFACTURE UNLESS ACCOMPANIED BY PROOF OF PURCHASE. Agri-Cover Inc.'s sole obligation under this Limited Warranty or any implied warranty is limited to the repair or replacement at its option, of defective parts only. No labor or service allowance is given or implied. IN NO EVENT SHALL AGRI-COVER, INC. BE LIABLE FOR INCIDENTAL, CONSEQUENTIAL, OR SPECIAL DAMAGES. EXPRESSLY DISCLAIMS ANY AND ALL IMPLIED WARRANTIES OF MERCHANTABILITY, AND THERE ARE NO WARRANTIES WHICH EXTEND BEYOND THE LIMITED WARRANTY DESCRIPTION CONTAINED HEREIN.

For warranty, have serial number ready and fill out the warranty claim form at agricover.com/warrantyclaim or call Customer Service Department at 800-233-4655 to determine if only a replacement part is needed or if the tarp needs to be returned for inspection and repair. Goods to be returned must have a pre-authorized RA # (Return Authorization Number) – obtained by calling the number above. Mark the number on the package and ship it freight prepaid to address below. Agri-Cover will pay freight to return goods to sender.

This Limited Warranty gives you specific legal rights and you may have other rights, which vary, from state to state.

For replacement parts shop at agricoverparts.com or call Customer Service at 800-233-4655.



Agri-Cover, Inc.
Customer Service Dept
3000 Hwy 281 SE
Jamestown, ND 58401
Phone: 800-233-4655

Hours: 8:00 am - 5:00 pm CST Monday through Friday, except Holidays