

TRUCK BOX COVER SPECIAL CLAMP INSTRUCTIONS



2019-ON CHEVY 1500 WITH BEDSIDE STORAGE BOXES

Read and follow these special instructions along with the standard instructions carefully before installing or using this cover.

NOTICE TO INSTALLER: Even if familiar with product, read special instructions prior to installation as improvements may be made without notice. Always handle components with care. When done, these special instructions must be given to the consumer.

NOTICE TO CONSUMER: Before using this product, read special instructions. Save these special instructions for future reference.

PREPARATION

TOOLS NEEDED

- 1/2" Wrench
- Ft-lbs torque wrench with 1/2" socket
- Protective eyewear

NOTE: Hardware and side rail appearance may vary.

⚠ CAUTION: Over torquing hardware may damage components.

1: INSTALLING CLAMPS

NOTE: When installing clamps, position as close to bends in box rail as possible.

IMPORTANT: Install clamps where 2 layers of sheet metal are present.

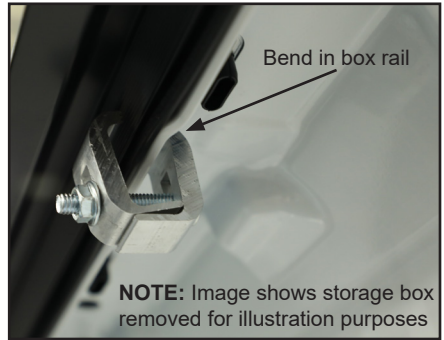

A. See below for clamp locations.

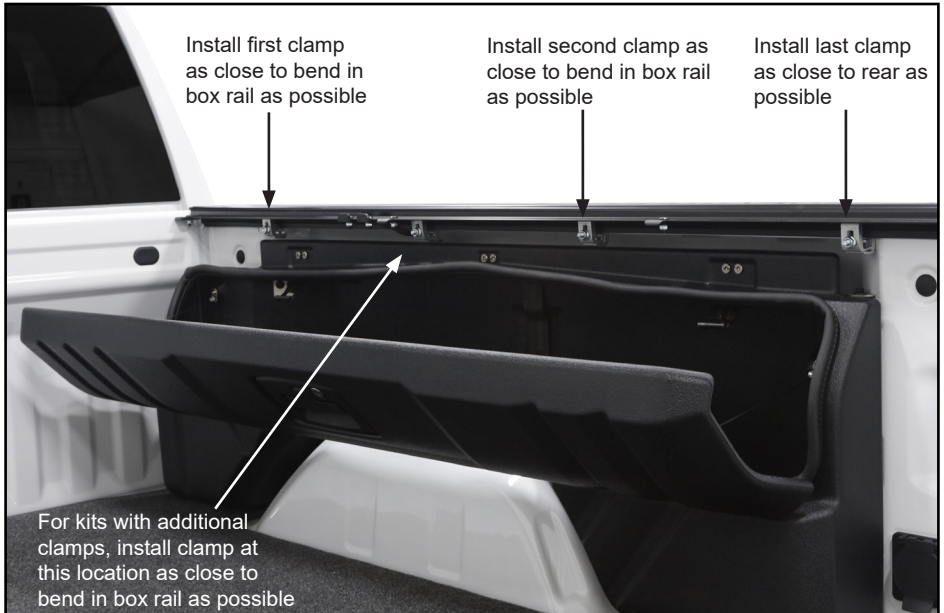

1: INSTALLING CLAMPS (Continued)

B. Open bedside storage box, angle clamp half and bolt through gap between box rail and top of bedside storage box.

C. Assemble clamp and loosely turn nut onto bolt to temporarily hold clamp in place.

D. Repeat procedure for second clamp and if applicable, additional clamp.

E. Place side rail between clamps and inside lip of box. Use standard instructions to position side rail.

F. Tighten clamps previously left loose with 1/2" wrench.

IMPORTANT: To keep side rail secured on truck, ensure clamp teeth engage grooves on side rail.

G. Ensure side rail is flush with top of box, then install last clamp as close to rear as possible.

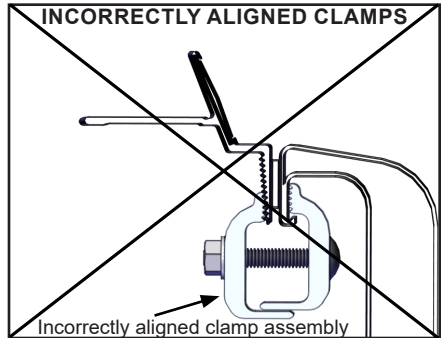
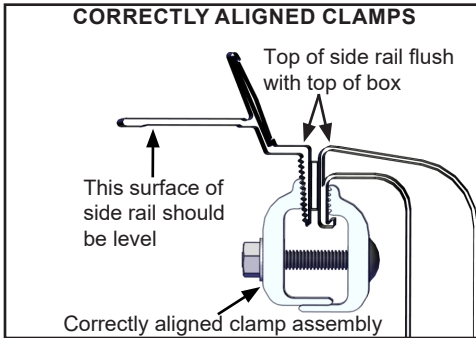

H. Ensure side rail is level and torque clamp nuts to 20 ft-lbs.

NOTE: Ensure bedside storage box lid opens and closes without interference from clamps. If clamps interfere, adjust as necessary.

I. Repeat Steps 1A-H to install side rail on opposite side.

J. For remaining cover installation, refer to standard instructions.

