

# HARD TRI-FOLD COVER REAR SEAL REPLACEMENT INSTRUCTIONS



**NOTICE:** Use these instructions to replace the rear seal on your hard tri-fold cover. Even if familiar with product, read instructions prior to use as improvements may be made without notice. Always handle components with care.

# PREPARATION

Unpack kit contents. The kit contains material to replace 1 rear seal.

## CONTENTS

- (3) Adhesive remover wipes
- (3) Alcohol pads
- (1) Rear seal
- (1) Scraper

## TOOLS NEEDED

- Protective eyewear
- Scissors
- Adhesive removal wheel (optional)

**▲ CAUTION:** Before using adhesive remover, read and understand all directions, warnings and precautions on adhesive remover packaging.

**▲ WARNING:** Do not use or store adhesive remover near fire or flame. Use in well ventilated area. Avoid contact with eyes. Do not breathe vapor. Keep out of reach of children.

**NOTE:** Be aware there are different types of rear seals, the installation process is the same for each type. Hardware appearance and components may vary.

## PARTS DIAGRAM - REAR SEAL IDENTIFICATION

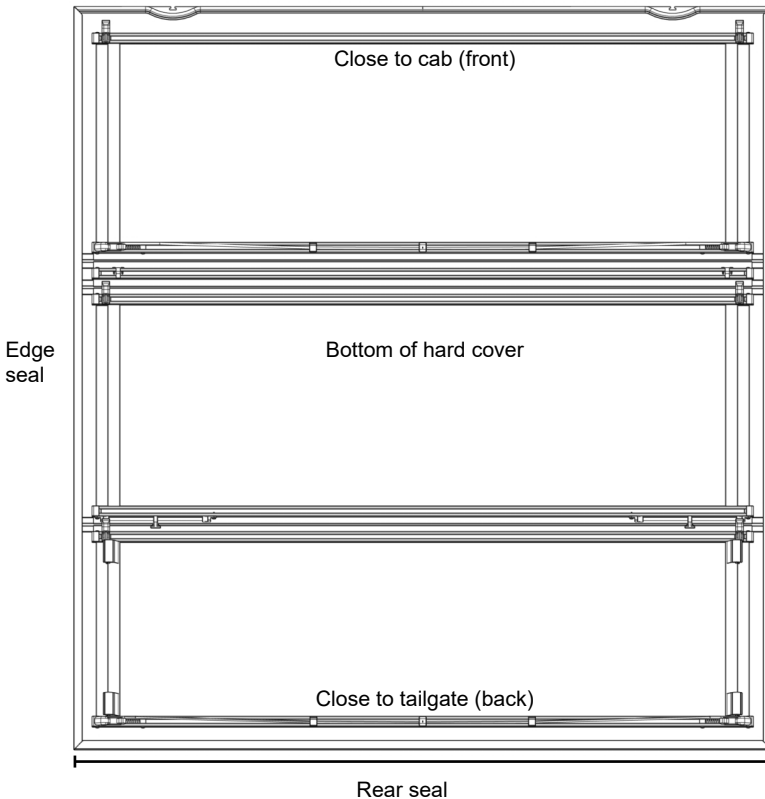

# 1: REMOVING OLD REAR SEAL

A. Clean and prepare flat work area. Place cloth, cardboard or tarp on work area to protect cover finish.

**NOTE:** Ensure work area accommodates unfolded cover length, width and weight.

B. Remove hard cover from vehicle. Position and unfold hard cover on work area with bottom facing up.

**NOTE:** For more information see Owner's Manual.

C. From one end of cover, slowly peel rear seal from cover while using the scraper to assist in removal of the seal.

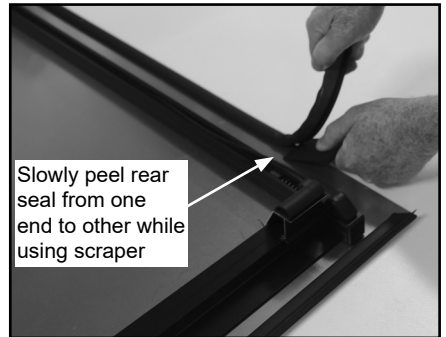
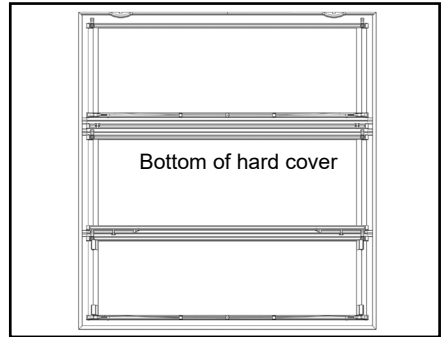

**NOTE:** In some cases, debris is left behind when removing the rear seal. Patiently use included non-marring scraper or optional adhesive removal wheel to remove debris.

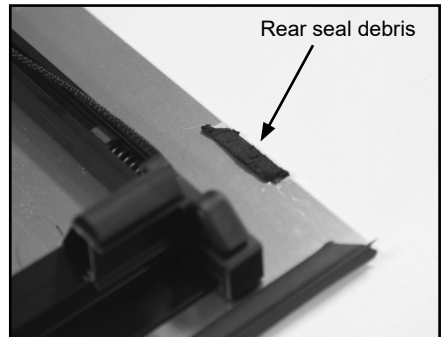

D. Use adhesive remover wipes to eliminate adhesive residue along the rear of the cover.

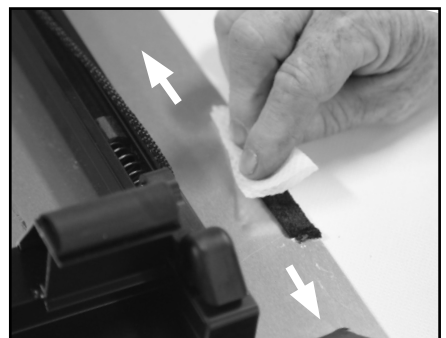

## 2: APPLYING NEW REAR SEAL

A. Clean rear of cover with alcohol wipes.

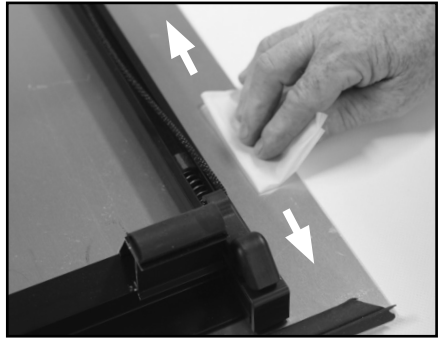

B. At one end of hard cover, use existing seal as guide to cut rear seal end to 45° angle.

C. Peel backing as you go and carefully apply rear seal flush across length of cover edge.

**⚠ CAUTION: Take care to not stretch rear seal while applying it.**

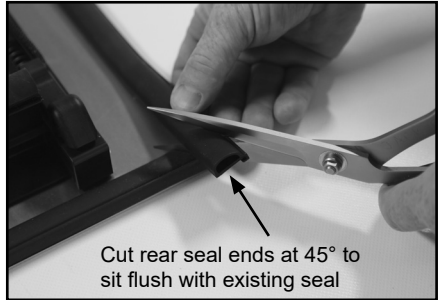

D. If needed, trim seal edges to make flush.

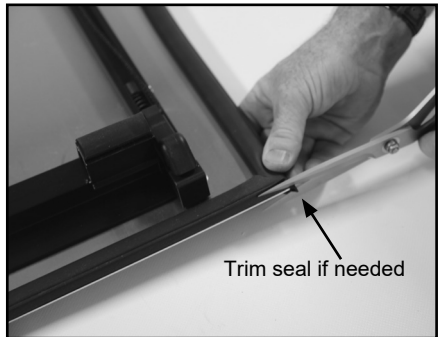

E. At opposite end, cut 45° angle to fit rear seal end flush with existing seal.

F. Firmly press rear seal down across the rear of the cover.

