



FOR New Tarp Remote Control Installation

Use these in place of the “rocker switch and solenoid “section of instructions in your roll tarp owner’s manual.

FOR Existing Electric Tarp Remote Control Installation

Disconnect (+) and (-) battery terminal connections. Disable existing switch and solenoid - they will not be used with this system. Install the remote control in accordance with these instructions included with remote control kit.

IMPORTANT!

READ AND UNDERSTAND THESE INSTRUCTIONS, WITH REMOTE KIT FOR SAFETY, INSTALLATION, DANGER, OPERATION, MAINTENANCE AND PROGRAMING FOR YOUR REMOTE CONTROL PRODUCT. SAVE ALL INSTRUCTIONS WITH YOUR ROLL TARP OWNERS MANUAL FOR FUTURE REFERENCE

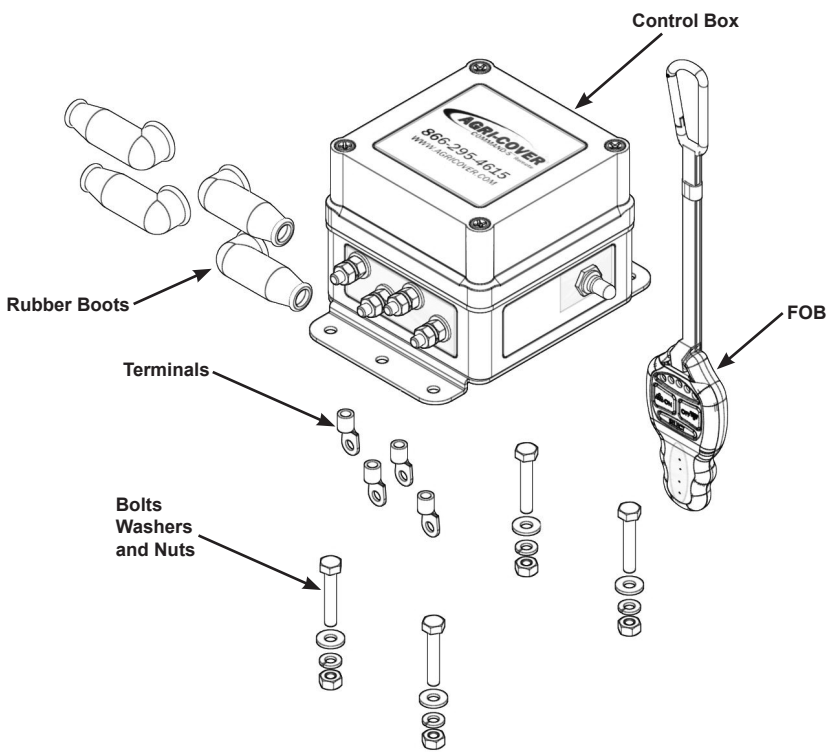

Parts Diagram (for part No. 80000)

Parts included: The above diagram shows only parts that are included in the Command-5 remote control kit. All other parts shown in the following instructions would be found in a new electric tarp kit or would be already installed on an existing electric tarp system.

Wiring Instructions

- 1** Note: There is ample heavy gauge wire supplied with each kit for standard installs. Before cutting wire, always preplan wire routing and make necessary adjustments as needed.

Route heavy gauge wire from battery to tarp motor. Allow ample wire where cutting and mounting connections take place. SEE Figure 1, box with hoist. Figure 2, semi-trailer box. Prepare wire ends for terminals, heat shrink tubes and rubber boots.

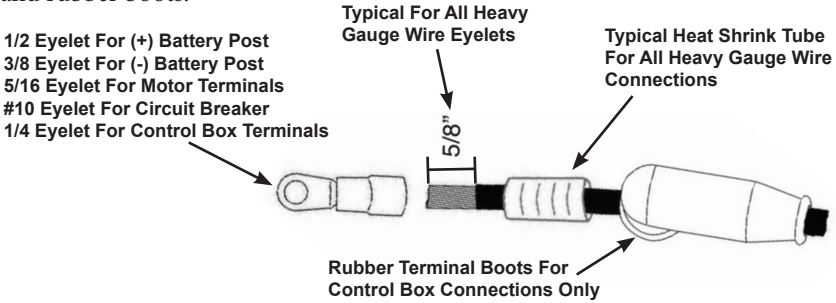

- 2** Mount remote control box to a rigid location at least 4 feet away from tarp motor. With terminals pointed down, use control box as template to mark hole drilling locations. Use bolts, nuts and washers to finish mounting. Attach heavy gauge wires to terminals on control box as shown. Slide rubber boots over terminals.

NOTE: Always hold base nuts when tightening top nuts on terminals.

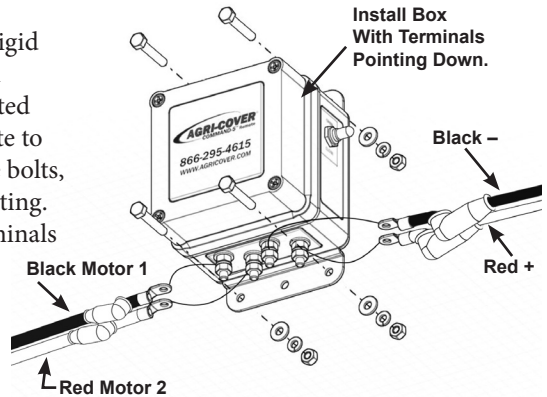

- 3** When on new tarp install attach tarp caution/operating decal to front driver side corner of truck box.

- 4** Attach heavy gauge wire to circuit breaker as shown near positive post on battery. Remember to seal with heat shrink first and slip wires through rubber circuit breaker cover (not shown).

IMPORTANT: Make sure system has a 40 amp modified reset circuit breaker installed as shown.

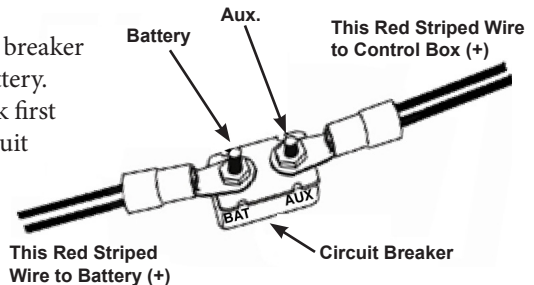

5

For TRAILER UNITS with Heavy Duty connector use terminals to attach wire to socket.

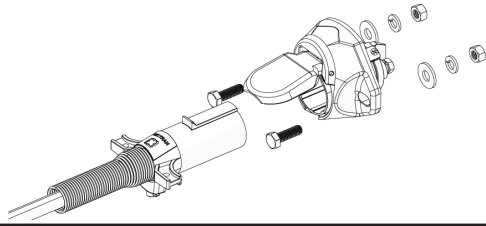

6

For motor terminal connections, if needed refer to electrical section of roll tarp owner's manual.

7

Now connect red wire to battery (+) post and then black wire to battery (-) post. Check operation of system. If system operates in reverse, switch motor wires under control box and retest.

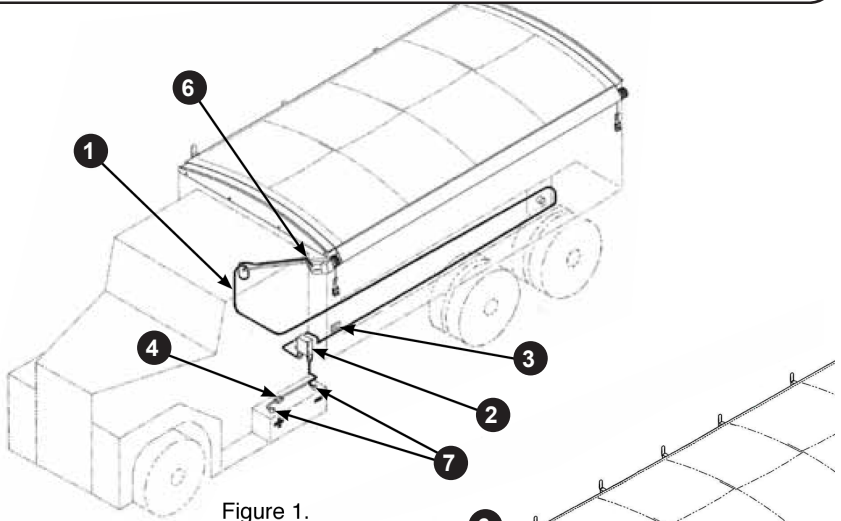

Figure 1.

See Wiring Schematic on Page 5

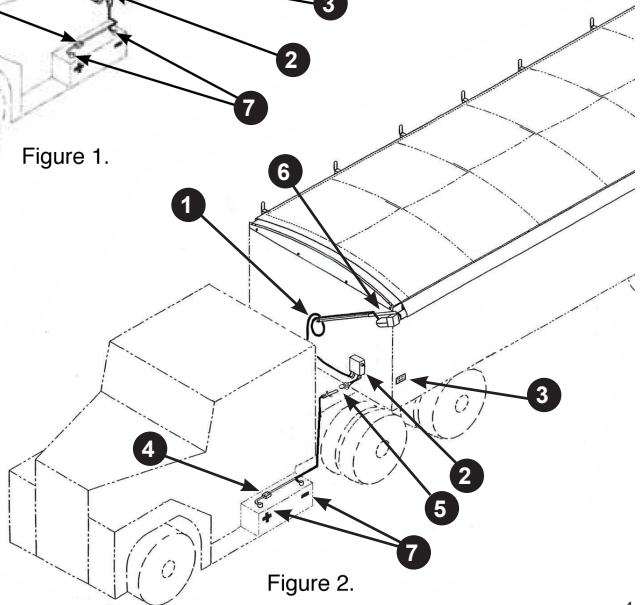
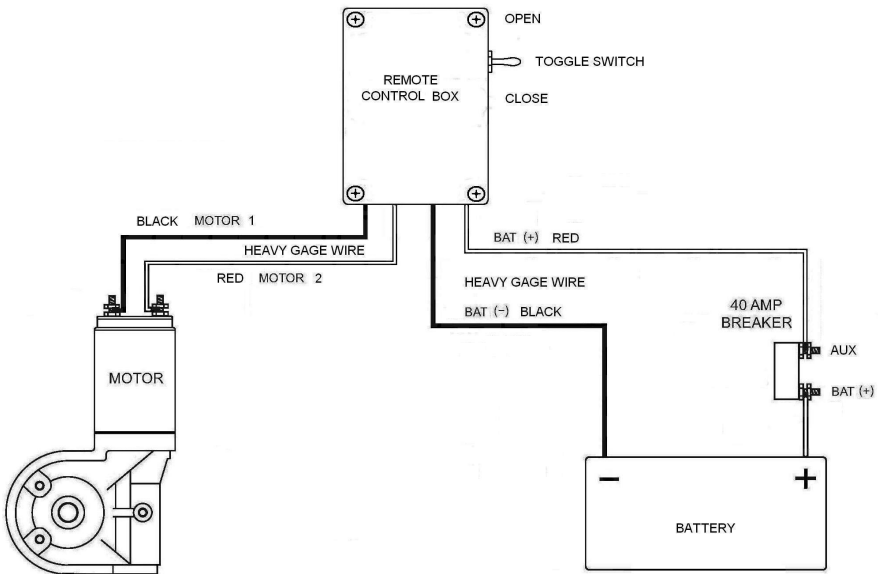

Figure 2.



WIRE SCHEMATIC

NOTE: This remote system requires a 40 amp modified reset circuit breaker. When operating, holding switch until circuit breaker trips is TOO LONG. When this occurs, breaker will trip and reset if overloaded by the motor. To reduce unnecessary strain on components, always release switch before breaker trips. If breaker trips and does not reset, it may have detected a continuous short and will not reset until short is repaired.

If installing this remote system on a existing unit, make sure there is a circuit breaker installed and that it is operating properly. If breaker is missing or malfunctioning, replace it with a correct new one. (40 amp modified reset circuit breaker)

Learning How to Use and Operate Your AGRI-COVER® Command-5™ Wireless Remote

Introduction

This wireless controller provides push-button wireless control. The key fob transmitter is simple to use and provides convenient reliable operation and is suitable for a wide variety of applications. The following instructions are directed to electric tarp installation and operation.

Safety Instructions

Do not install or use this product before you read and understand these instructions and the information contained in them. Only allow persons who know and understand the safety rules to use this remote control.

1. Never allow children to operate or play around with remote tarp system.
2. The tarp should only be operated when operator has clear visibility of the entire tarp.
3. Lock-out the wireless remote when you are not operating the tarp to avoid unintended operation.
4. Disconnect power from the motor before servicing tarp system.

Operating Instructions (how to use fobs pre-programmed mode to open and close tarp)

Your roll tarp system can be operated wirelessly by the remote key fob. The key fob is designed to provide safe and easy operation of the tarp and features an auto-lock mode to help prevent unintended operation.

Step 1 – To Unlock Key Fob

When key fob is in lock mode, all 5 indicator lights will light up when pressing any button (Figure 1). To unlock fob, press and hold both ON and OFF buttons at the same time for 3 seconds. The far left light will start blinking (Figure 2). (If fob is left idle for 3 minutes or longer, it will automatically go into lock mode.)

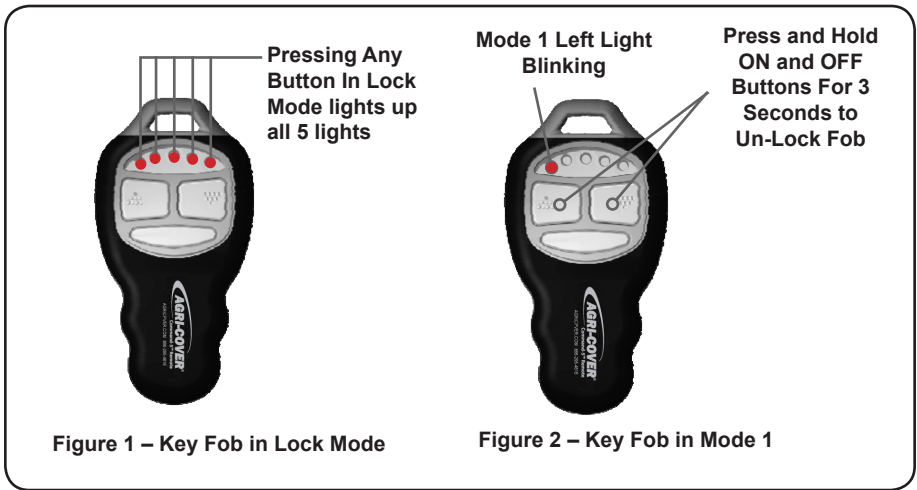

Step 2 – To Open or Close Tarp

Your system has been pre-programmed to operate the tarp in Mode 1 which is the far left indicator light. Press and hold the ON button to roll tarp CLOSED. Press and hold the OFF button to roll tarp OPEN. Light will stay lit continuous when pressing ON / OFF button (Figure 3).

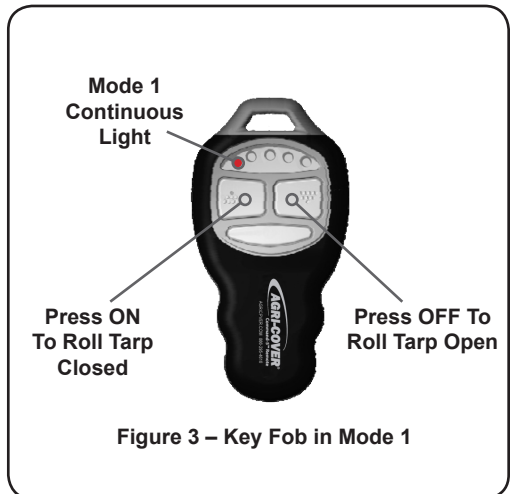

Step 3 – To Lock Key Fob

To manually lock key fob, press and hold both ON and OFF buttons at the same time for 3 seconds. Flashing light indicator will stop, indicating fob is in lock mode (Figure 4). If fob is unlocked and left idle for 3 minutes or more, it will automatically go into lock mode. Fob is in lock mode when pressing any button and all 5 indicator lights light up.

Press Both ON
and OFF
Buttons For 3
Seconds to
Manually Lock
Fob



Figure 4 – Key Fob in Lock Mode

Note: Once installation is completed, always verify your systems operation before putting it to use, to ensure that:

- 1) the fobs selected mode operates the intended motor and
- 2) when pushing the ON or OFF button, it performs the intended function.

Installation of the wireless remote control in its pre-programmed mode is now complete.

The remaining instructions are for programming options such as additional modes, fobs and receivers for a variety of extra functions.

Specifications

Supply Voltage	12V DC
Key fob battery	23A 12V (requires 2 – included)
Operation	Key Fob (1 included) Manual Switch

Receiver Modes	Functions On Fob
Mode 1 (pre-programmed)	Press ON = To Close Tarp Press OFF = To Open Tarp
Mode 2	
Mode 3	
Mode 4	
Mode 5	

Optional Instructions to Enable and Program Additional Modes on Key Fob

Note: Mode 1 (tarp) cannot be disabled. During program mode, if fob is left idle for more than 10 seconds, it will return to operating mode.

Turn key fob on. Press and hold SELECT button for 10 seconds until far left light is on continuous (Figure 5). The fob is now in programming mode. Press ON button to enable current mode shown by lit LED or press OFF button to disable current mode shown by lit LED. Indicator light for modes will turn off and automatically advance to the next mode when programming. After all 5 modes are programmed, the fob will display the status of all 5 modes for ten seconds. All enabled mode LED's will be lit and all disabled mode LED's will not be lit. Fob buttons will not function during this ten second time.



Figure 5



Figure 6 – Key Fob in Mode 2

Instructions to Re-Program Key Fobs or Receivers

Your Roll Tarp Wireless System is typically pre-programmed at the factory ready to use. Re-programming is necessary if replacement fobs or receivers are installed. Use programming method below to program receiver to accept/respond to signals from up to 5 key fobs.

1. Gain access to receiver inside control box.
2. Make sure receiver is connected to power source. If ON/OFF switch is installed, turn it on.
3. The receiver can learn to recognize and respond up to 5 key fobs. Gather all fobs to be introduced to the receiver.
4. Set fobs to appropriate mode. (Tarp, Front Trap, etc.)

Read the following steps fully before proceeding. Steps 6 through 7 must be completed within 10 seconds.

5. Press and hold programming button on receiver for 3 seconds. (See Figure 7 below) The receiver will beep to indicate it is in programming mode, then release button.
6. Press ON button on the first fob being introduced. The receiver will beep after receiving fobs transmitted signal. Repeat this step for any additional fobs.
7. The receiver is expecting 5 signals. If you are programming less than 5 fobs, press the ON button a total of 5 times. **Example:** If programming 3 fobs, each with 1 functioning signal, you would press ON button on fob #1= one time, on fob #2= one time, and on fob #3= three times for a total of five times between all 3 fobs (the last two times completes the five signals the receiver is expecting).
8. After pressing ON button 5 times, the receiver will beep 2 times to indicate it has been programmed successfully. NOTE: After 10 seconds, the receiver will exit program mode.
9. Verify that each fob is operating correctly. If fobs are not operating correctly, verify there is 12 to 14 volts from receiver positive to negative, then repeat Steps 3 to 8.

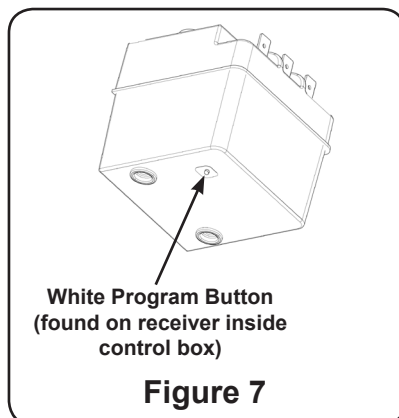

Instructions to Program a Receiver (To More Than 1 Fob)

To program a receiver that controls the tarp motor to recognize more than 1 fob. Example given below does 3 fobs.

1. Remove control box cover. Turn 3 fobs on.
2. Set all 3 fobs to same tarp motor.
3. Press and hold programming button on receiver for 5 seconds. Receiver will beep to indicate it is in Programming Mode. Release programming button.
4. Press ON button on 1st fob. Receiver will beep to indicate it has received a signal, and memory slot #1 has been filled.
5. Press ON button on 2nd fob. Receiver will beep to indicate is has received a signal and memory slot #2 has been filled.
6. Press ON button on 3rd fob. Receiver will beep to indicate it has received a signal and memory slot #3 has been filled.
7. Press ON button on 3rd fob again. Receiver will beep to indicate it has received a signal and memory slot #4 has been filled. (this is needed to clear any pre-existing memory in #4)
8. Press ON button on 3rd fob again. Receiver will beep twice to indicate it has received a signal and memory slot #5 has been filled. The double beep also indicates receiver has exited programming mode. (this is needed to clear any pre-existing memory in #5)
9. Verify that tarp motor Open and Close operations function correctly on all 3 fobs. Re-attach cover on control box. **(Fob button functions: Push ON button to CLOSE tarp, push OFF button to OPEN tarp.)**

Battery Replacement

Your wireless key fob is powered by two 23A 12V batteries. If key fob becomes un-responsive replace batteries.

To change batteries, remove 4 screws from back of fob using a small phillips screwdriver. Carefully remove front of fob exposing two batteries. Replace both batteries with two of same brand and size. Reassemble key fob by carefully placing both halves together. Make sure grey colored gland in front half stays in place during assembly. Reassemble all four screws.



Trouble Shooting Receiver

Problem Issue:	Check or Try...
1. Two different motors operate at the same time when using fob remote.reprogram receiver that is malfunctioning. (Review receiver programming page 10 with attention to Step 7)
2. System will not operate with fob remote or toggle switch. (Cannot hear a clicking noise from receiver inside control box.) if system has a master control switch, make sure it is turned to "ON" position. auto circuit breaker may have tripped. Wait several minutes and try again. If it still does not work circuit breaker may have detected a continuous short and must be repaired check vehicle's battery, charge or replace if dead. check all wire connections on vehicles battery. Check all wiring for loose or corroded connections. Verify that battery has at least 12 volts on battery terminals under control box. check for loose or shorted together connections on receiver. Verify there is at least 12 volts power from positive to negative terminal post. verify that positive and negative wires from battery are connected to correct terminals at control box. See wire schematic page 5.

Trouble Shooting Receiver Cont'd

Problem Issue:	Check or Try...
<p>3. System will not operate with fob remote or toggle switch. (Can hear a clicking noise from inside receiver control box—but nothing happens.)</p>	<p>.....verify there is at least 12 volts on back side of receiver on battery hookup posts.</p> <p>..... remove control box cover and check connections on receiver, making sure they are tight and none are shorted together. Verify there is at least 12 volts from positive to negative terminal post on relay.</p> <p>..... push toggle switch in Open or Close position while checking voltage across IN and OUT terminal posts. Should have 12 volts between these posts while holding switch down. When releasing switch, there should be close to 0 volts between posts. If not, replace receiver solenoid.</p> <p>..... if above checked okay, then motor may be damaged.</p> <p>Replace motor.</p>
<p>4. The key fob and toggle switch will operate the tarp motor, but motor turns freely and tarp doesn't move.</p>	<p>.....check bolt connections in shaft between motor and tarp tube. If missing, replace sheared bolt with grade 5 of same size.</p> <p>..... check tarp system for damaged or misaligned parts and correct as needed.</p>

Trouble Shooting Key Fob

Problem Issue:	Check or Try...
<p>1. Key fob transmitter doesn't work. None of the lights turn on when remote is turned on.</p>	<p>.....check fob for dead batteries, make sure batteries are loaded correctly in remote.</p> <p>..... remove batteries and make sure contacts are tight and not corroded. Reinsert batteries and try again.</p> <p>.....batteries may be dead, replace with new quality high capacity batteries.</p> <p>.....damaged fob transmitter, replace fob.</p>
<p>2. Key fob transmitter doesn't work. System operates with toggle switch but not with remote fob. The key fob channel light (tarp system, for example) is blinking, and when pressing ON button, the light blinks continuously.</p>	<p>..... make sure fob is set to correct mode. If fob cannot be set to correct mode, reprogramming is needed (see fob programming instructions).....make sure no other fobs are being used near this system.</p> <p>.....to determine if fob transmitter is the problem, test with a different receiver or by using a second fob. If receiver is the problem, try reprogramming. If that doesn't work, replace receiver inside control box.</p> <p>.....be sure to be within several feet of receiver and try again. If fob transmitter works at short range but not long range, replace battery. If battery is not the problem, replace remote fob.</p>
<p>3. Key fob transmitter doesn't work. Key fob mode light is blinking, but when pressing ON or OFF button, the light goes out or just continues to blink at same speed.</p>	<p>.....remove batteries and make sure contacts are tight and not corroded. Reinsert batteries and try again.</p> <p>..... batteries may be dead, replace with new high capacity batteries.</p> <p>.....fob transmitter is damaged. Replace fob.</p>

Trouble Shooting System

Problem Issue:	Check or Try...
<p>1. System will not operate with toggle switch or with fob transmitter. Motor engages but stalls and tarp does not turn.</p>	<p>..... if system was just installed, check to see if tarp operates in opposite direction. If so, see wiring installation about reversing wires.</p> <p>.....check condition of tarp and alignment.</p>
<p>2. Key fob transmitter doesn't work. System operates with toggle switch but not remote fob. The key fob channel light (tarp system, for example) is blinking, and when pressing the ON button, the light blinks continuously.</p>	<p>.....shut off power to system and remove bolt that engage motor shaft to tarp tube. Restore power to system.</p> <p>.....if motor doesn't begin to run, press toggle switch to engage motor.</p> <p>..... if motor begins to run and will not stop, pull center wire from toggle switch. If motor stops, the toggle switch is faulty and must be replaced. If motor keeps running, make sure all receiver connections on are tight and not shorting together. Verify there is at least 12 volts from positive to negative post. If connections are good, then receiver is faulty and must be replaced.</p>
<p>3. Motor keeps running after toggle switch is released. Toggle switch is sticking.</p>	<p>..... check switch for excessive dirt, debris etc. Clean if dirty. Replace toggle switch if it continues to stick after cleaning.</p>
<p>4. System has a motor running in wrong direction.</p>	<p>.....if system was just installed, reverse wires connected on tarp motor terminals.</p>