



SRT-2 FLEX DRIVE REPLACEMENT (for SRT-2 on Belly Dump Trailers)

NOTICE INSTALLER: USE THESE INSTRUCTIONS TO REPLACE BOLT-ON FLEX DRIVE TO HANDLE AND TO REPLACE FLEX DRIVES WELDED TO HANDLE

WHEN FLEX DRIVE AND HANDLE ARE BOTH PREPPED FOR BOLT-ON ASSEMBLY:

TOOLS: 1/2" wrench (2), torque wrench ft. lb. with 1/2" socket

- 1) Slide open end of flex drive onto open end of handle. Align holes.
- 2) Insert bolt through handle, turn nut on and tighten. See diagram A.
- 3) Torque bolt to 19 ft. lbs.

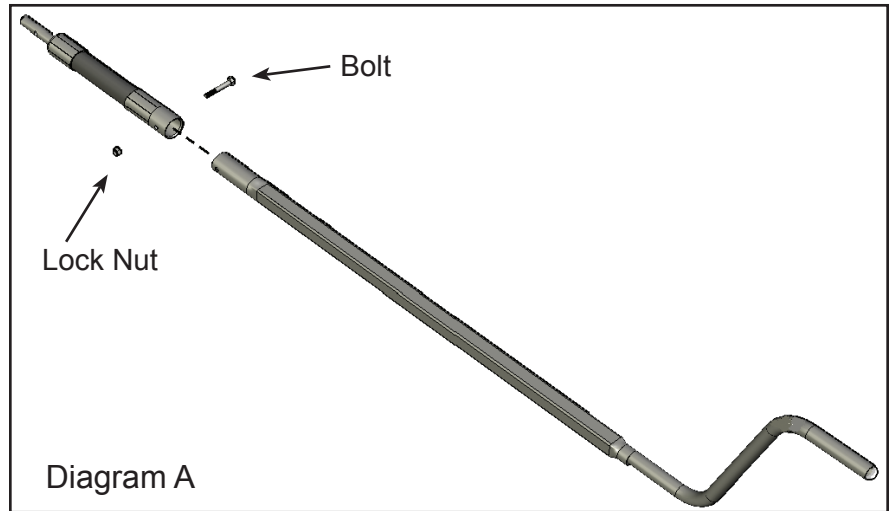

TO CONVERT AN EXISTING WELDED-ON FLEX DRIVE TO A BOLT-ON ASSEMBLY:

TOOLS: Protective eyewear, metal hand saw, 1/2" wrench (2), welder and torque wrench ft. lb. with 1/2" socket.

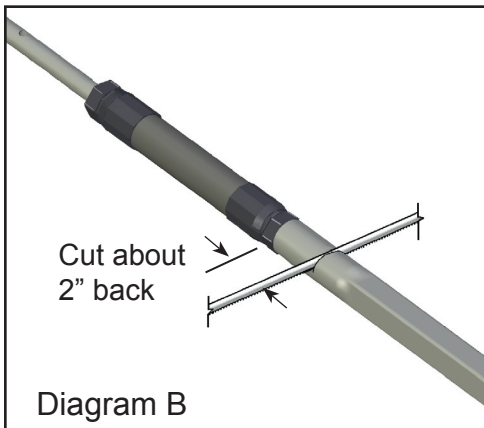

- 1) Measure back 2 inches and cut existing welded flex drive off of handle.

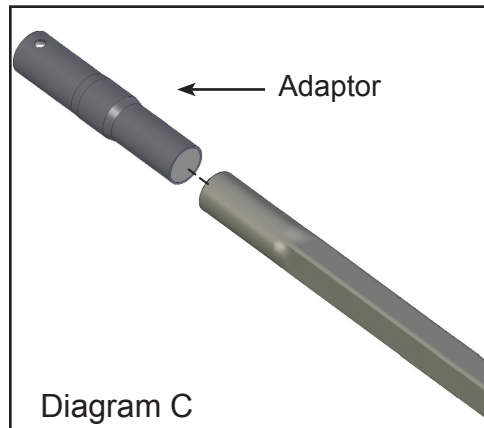

- 2) Orientate bolt on style adaptor with end of handle as shown. Insert it fully into end of handle.

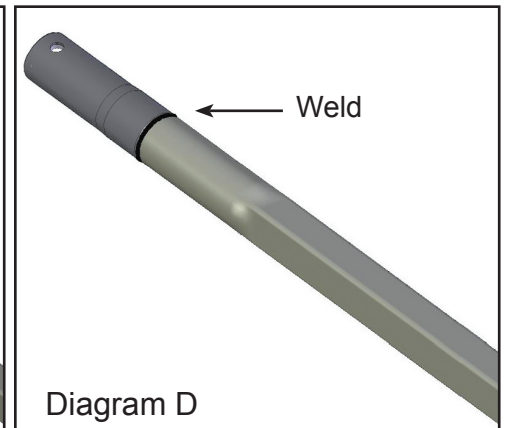

- 3) Apply fillet weld around joint of adaptor and handle. Then bolt replacement flex drive to adaptor on end of handle. Tighten bolt to 19 ft. lbs. of torque (See diagram A above).