

**Suggested Tools:**

- a) ratchet
- b) 1/2" deep socket
- c) 18" long extension
- d) torque wrench ft. lb.
- e) 1/2" box wrench
- f) protective eyewear

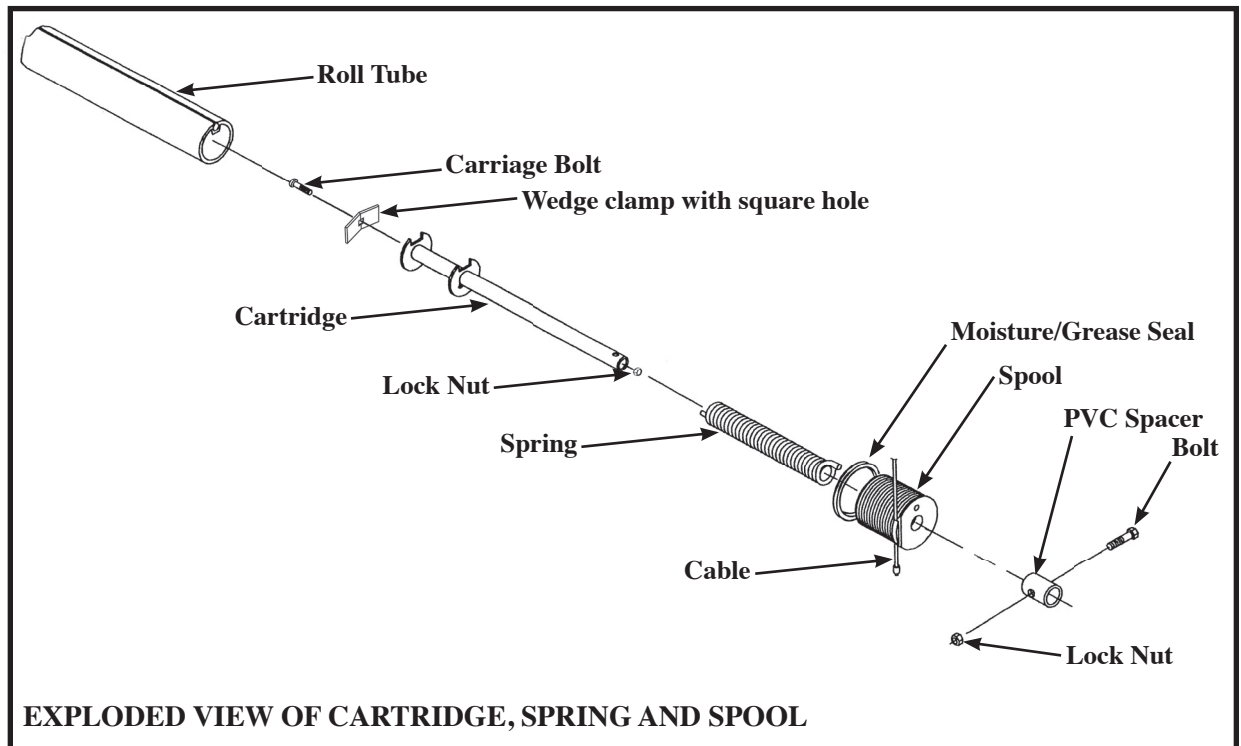

**TO REMOVE EXISTING CARTRIDGE:**

- 1) Release cable tension with ratchet.
- 2) Unwrap cable-note orientation of wrap for reassembly.
- 3) Remove lock nut, bolt and PVC spacer that hold spool on.
- 4) Remove spool- clean inside of spool and outer side of roll tube area that spool turns on. Apply teflon grease to inside of spool for reassembly later.
- 5) Note orientation of torsion spring and mark exposed tab end for reassembly. Then remove spring.
- 6) Use long extension with 1/2" deep socket and loosen existing bolt inside cartridge. Then pull assembly out.

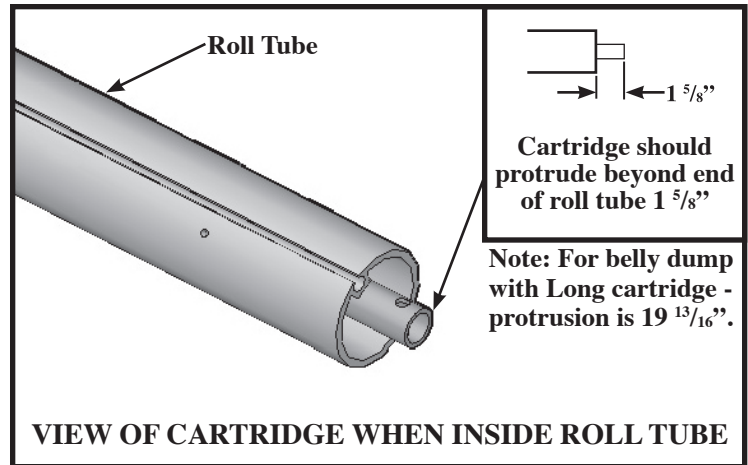

**ASSEMBLE REPLACEMENT COMPONENTS/ CARTRIDGE:**

- 1) Assemble wedge clamp to cartridge. Make sure wedge clamp is positioned as shown in exploded view. Turn lock nut just tight enough to prevent carriage bolt from spinning.
- 2) Place cartridge assembly inside roll tube and adjust it to protrude out as shown. **Tighten lock nut to 20 ft. lbs.** This will expand the wedge clamp securing cartridge in its proper position.
- 3) Insert spring -with end marked when removed- to outside.
- 4) Slide freshly greased spool on roll tube and turn until spring tab engages hole on spool.
- 5) Replace PVC spacer with its bolt and tighten lock nut. Push moisture grease seal up against spool.
- 6) Wrap cable around spool. Apply tension with ratchet. Watch cable groove on spool, as tension is applied, the spool turns. Proper tension is when the spool makes about 1/4 to 1/3 of a turn.

**TIP: For best tarp performance - periodically clean and grease spools at both ends.**

**For complete SRT-2 installation instructions go to: [WWW.AGRICOVER.COM](http://WWW.AGRICOVER.COM)**