

PREPARATION

TOOLS NEEDED

- Ratchet
- 1/2" Deep well socket
- 18" Long extension
- Ft-lbs Torque wrench
- 1/2" Box wrench
- Protective eyewear

NOTE: Before cutting ensure there is room for splicing.

NOTE: Hardware appearance and components may vary.

PARTS DIAGRAM

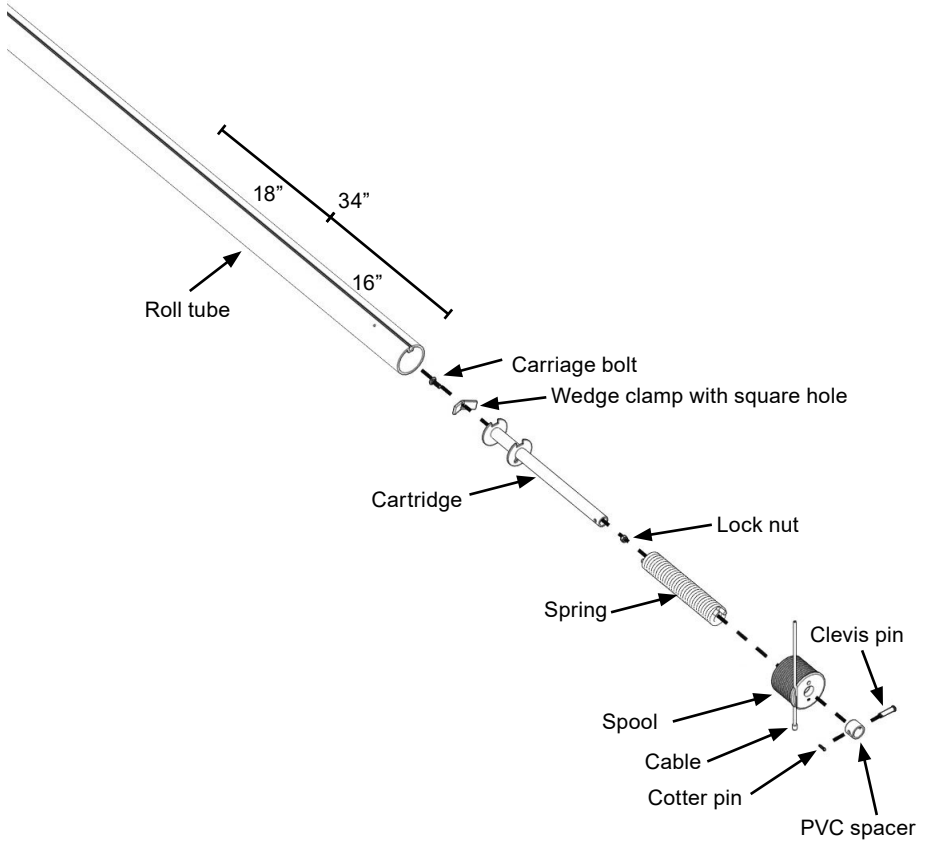

1: REMOVE EXISTING CARTRIDGE

A. Release cable tension with ratchet. Unwrap cable, record orientation of wrap for reassembly.

B. Remove cotter pin, clevis pin and PVC spacer that secure spool. Remove spool and rubber ring (if present). Thoroughly clean outer area of roll tube where spool turns and inside of spool.

NOTE: Discard rubber ring if present.

C. Record orientation of torsion spring and mark exposed tab end for reassembly, then remove spring.

D. Use long extension with 1/2" deep socket to loosen existing bolt inside cartridge, then remove assembly.

E. Repeat step for opposite end.

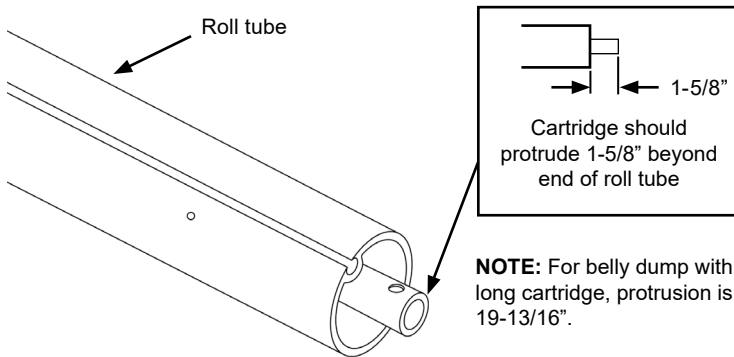

VIEW OF CARTRIDGE WHEN INSIDE ROLL TUBE

2: REASSEMBLE CARTRIDGE

A. Assemble wedge clamp to cartridge. Ensure wedge clamp is positioned as shown in parts diagram. Turn lock nut just tight enough to prevent carriage bolt from spinning.

B. Place cartridge assembly inside roll tube and adjust it to protrude out as shown. Torque lock nut to 20 ft-lbs.

C. Insert spring (with end marked when removed in Step 1C) to outside.

D. Slide spool on roll tube and turn until spring tab engages hole on spool.

E. Use clevis pin to reinstall PVC spacer and secure with cotter pin.

F. Repeat step for opposite end.

2: REASSEMBLE CARTRIDGE (Continued)

IMPORTANT: To prevent scratching or gouging, temporarily insert cardboard between box and ratchet hooks.

G. Cable tension is easily determined by position of the tension channel on front and rear spools. As tension is applied with ratchet, the spool turns. Watch the tensioning channel on side of spool. Proper tension is achieved when the tension channel is level at bottom.

TIP: For best tarp performance, periodically clean both spool ends.

TIP: Tighten ratchet an additional two clicks past level. Open and close tarp system, approximately five times to allow cable to seat in spool grooves and tarp material to pull snug. Tension channel should be in the level position. Periodically check tension level during use.

H. Repeat step for opposite end.

