

# Hard Tri-Fold Cover Special Clamp Instructions



## Special Instructions for 2014-ON Chevy/GMC 1500 Half Ton and 2015-ON Chevy/GMC 2500 and 3500

**INSTALLER:** These instructions must be given to the consumer.

**CONSUMER:** Save this insert for future reference.

**READ AND FOLLOW THESE SPECIAL INSTRUCTIONS ALONG WITH  
THE STANDARD INSTRUCTIONS CAREFULLY BEFORE INSTALLING  
OR USING THIS COVER.**

Actual parts may vary from those shown in this booklet.

# 1: TYPICAL CLAMP SPACING

This clamp kit contains 6 regular clamps and 2 long clamps (used at the rear of the box).

**NOTE: At all locations, install clamps where 2 layers of sheet metal are present.**

A. Position side rail per instructions in the owner's manual. Place first clamp 11" back from front of bulkhead (see diagram below).

**NOTE: If your cover came with 2 piece rails, please refer to special rail instructions for clamp locations.**

B. Place second and third clamps 6" in each direction from the center of the box (see diagram below).

C. Long clamps will be used at the rear of the box. These clamps utilize the rear stake pocket to secure the cover rail to the side rail of the truck box. See Step 2 for installation procedure of these clamps. If the stake pocket is unavailable, use alternate location for long clamps (see back page for this location).

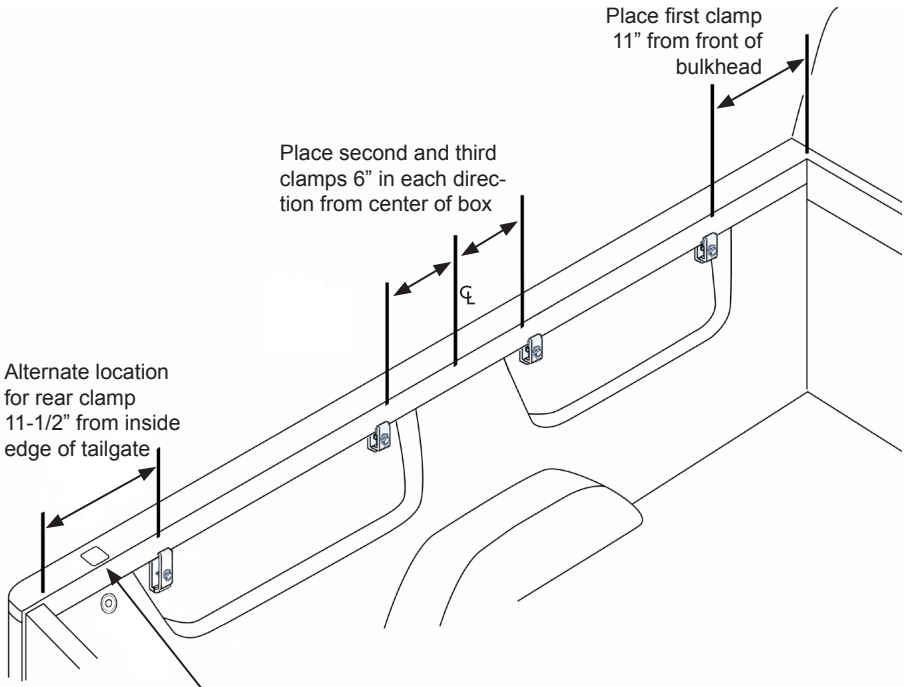

**NOTE: Use long clamp at rear stake pocket location. See installation procedures in Step 2.**

## 2: INSTALLING LONG CLAMPS

**NOTE:** For best adhesion, air and surface temperature should be above 60° F.

A. After short clamps are installed as previously shown, at rear of box under large hole in line with stake pocket, clean area and apply adhesive protective strip.

**NOTE:** If box has drop-in liner, cut liner to clear room for clamp.

B. At top of rear stake pocket, lower back half of long clamp with fish wire and carriage bolt down into pocket.

C. Using fish wire, align and pull bolt through hole on inside wall of box and hold there for next step.

D. Place other half of clamp over bolt and turn nut finger tight.

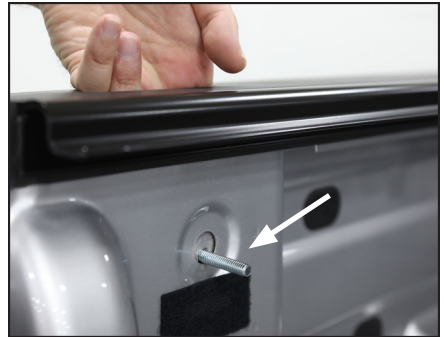
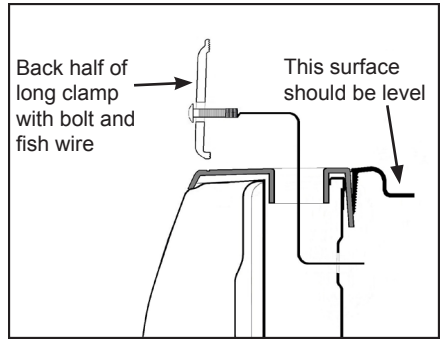

## 2: INSTALLING LONG CLAMPS (Continued)

E. Adjust side rail height to clear tailgate as specified in owner's manual and hold. Push clamp up under side rail and tighten bolt. Torque this bolt to 20 ft. lbs. Repeat for opposite side.

**IMPORTANT: Make sure clamps are lined up properly prior to tightening bolt. (See diagrams below)**

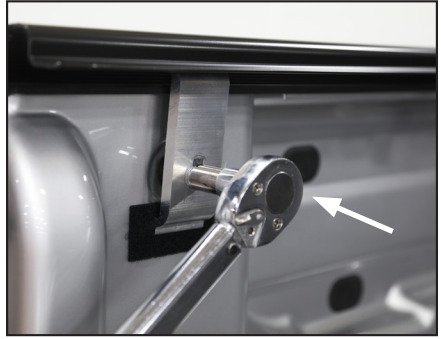

**ALTERNATE LOCATION OF LONG CLAMP - only if stake pocket is not available, use shim at this location.** Even if stake pocket is utilized with an accessory, remove it and check for space. Usually the long clamp will install down in the pocket and still allow the accessory to be remounted.

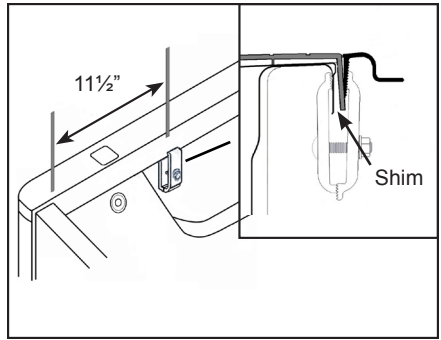

### Tall Clamps Inside Rear Stake Pocket

