

## MANUAL OVERRIDE ADAPTOR INSTRUCTIONS

Use these instructions to install manual override adaptor. Read and follow these instructions along with the standard instructions carefully before installing or using tarp system.

**NOTICE TO INSTALLER:** Even if familiar with hardware, read instructions prior to installation as improvements may be made without notice. Always handle components with care. If you have questions or problems, call customer service. When done, these instructions must be given to the consumer.

**NOTICE TO CONSUMER:** Before using this product, read special instructions. Save these instructions for future reference.



Questions? 800-233-4655  
agricover.com

# PREPARATION

## COMPONENTS

- (2) Decals
- Drive cartridge
- Vinyl cap
- Spline adaptor
- Clevis pin
- Cotter pin
- Drive rivet

## TOOLS NEEDED

- (2) 9/16" Socket and wrench
- 3/4" Socket and wrench
- Drill with 5/16" bit
- Hammer
- Tape measure
- Marking pen
- Protective eyewear

**⚠ CAUTION:** Disconnect power to electric tarp motor before attempting to install manual override adaptor.

**⚠ CAUTION:** Never open or close tarp without U-joint secured to spline shaft with wire lock pin.

**NOTE:** Requires a fully assembled crank handle with 21 spline U-joint and crank handle holder for temporary use on electric operated roll tarp.

## 1: INSTALL SPLINE ADAPTOR

A. Align grooves then slide drive cartridge in rear end of roll tube.

B. Slide vinyl cap onto end of roll tube, ensuring drive cartridge shaft extends 2" from vinyl cap.

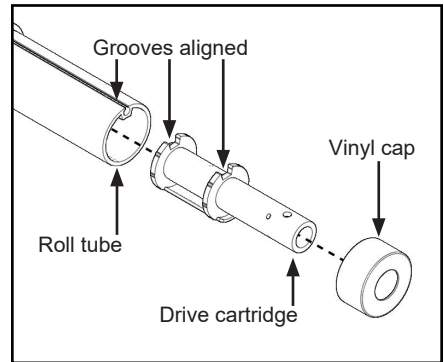

C. Mark 6-1/2" in from end of drive cartridge on opposite side of rope channel.

D. Drill 5/16" hole through roll tube and first wall of drive cartridge then insert drive rivet and set with hammer.

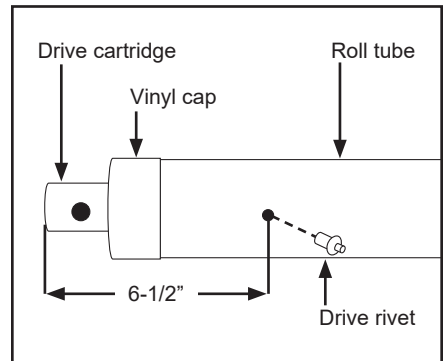

# 1: INSTALL SPLINE ADAPTOR (Continued)

E. Slide spline adaptor into drive cartridge shaft, aligning holes, then insert clevis pin and secure with cotter pin.

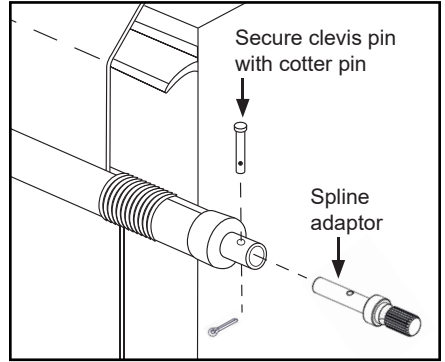

# 2: SETTING TARP TENSION

A. Attach handle to spline adaptor then secure with wire lock pin.

**NOTE:** Crank handle can now be used to maneuver tarp roll.

B. Remove cotter pin from clevis pin holding motor shaft to front of roll tube. Instruct someone to rotate handle with both hands to relieve pressure on clevis pin while it is removed.

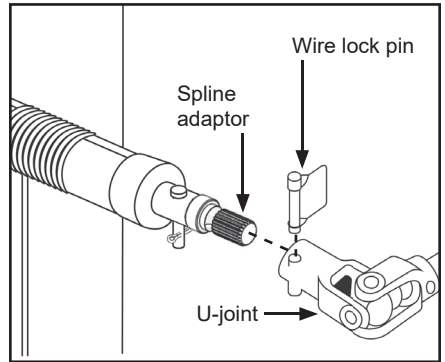

C. Crank roll tube up under latch plate then lower handle to a vertical position and lift toward center of box to mark location for handle holder.

**NOTE:** Handle holder should be mounted above crank handle

D. Use holes in mount to mark and drill (2) 5/16" holes into box then secure with (2) 3/8" x 1" hex bolts, flat washers, lock washers and nuts. Attach handle holder to mount using 1/2" x 1" flange bolt with spacer.

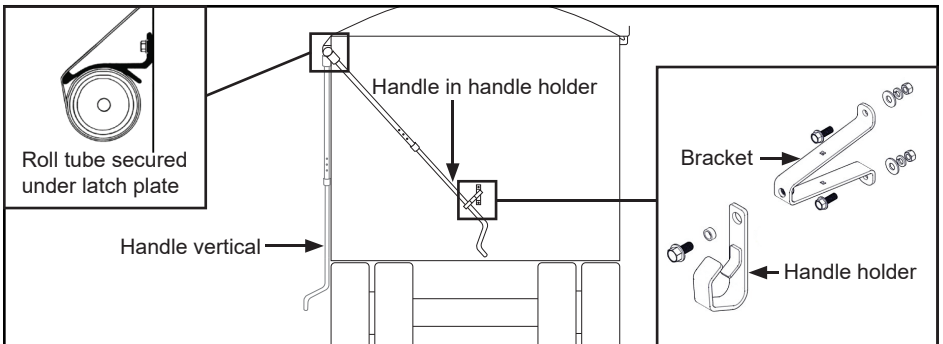

## 2: SETTING TARP TENSION (Continued)

E. Ensure roll tube is secured under latch plate and lift handle into handle holder.

Pressure required to place handle into holder depends on length of handle:

- 8' = 25 lbs.
- 10' = 20 lbs.
- 12' = 15 lbs.

**IMPORTANT:** Maintain recommended tension or excessive tarp wear may occur.

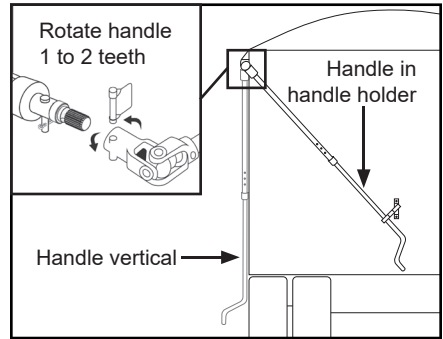

**NOTE:** To adjust tension, unroll tarp and remove all tension. Rotate handle 1 to 2 teeth, reassemble and check tension. Repeat until proper tension is achieved.

## 3: APPLY DECALS

**NOTE:** For best adhesion, ensure air and surface temperatures are above 60°F.

A. Clean surface with alcohol, then adhere operating decal near handle holder and moving parts decal near ladder.

